

folding your stroller:

1 unlock canopy

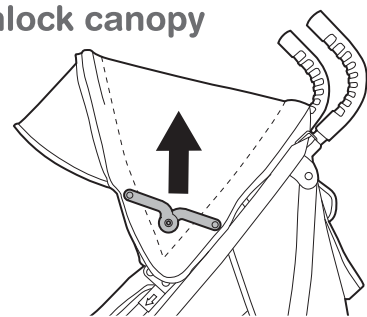

2 push safety lock lever down and pull up on the folding handle at the same time

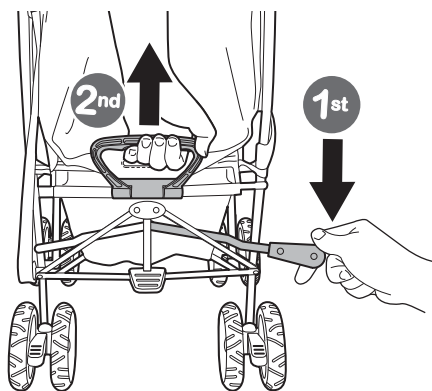

3 push forward and down

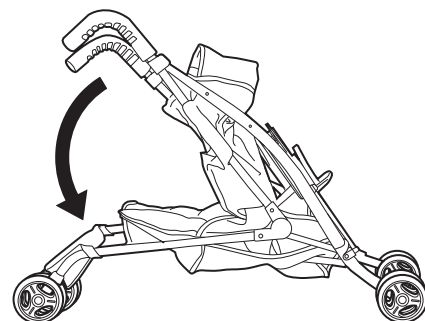

4 throw over your shoulder and GO!

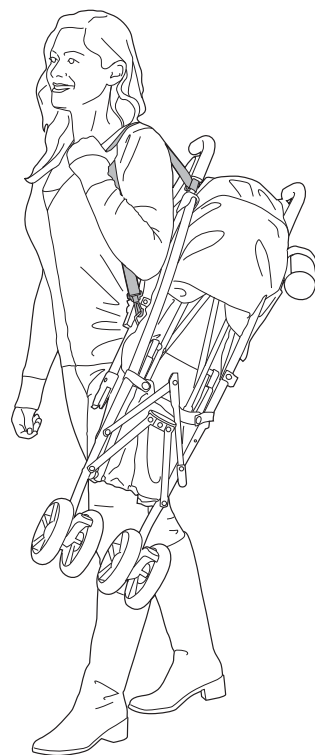

reattaching the storage basket:

snaps!

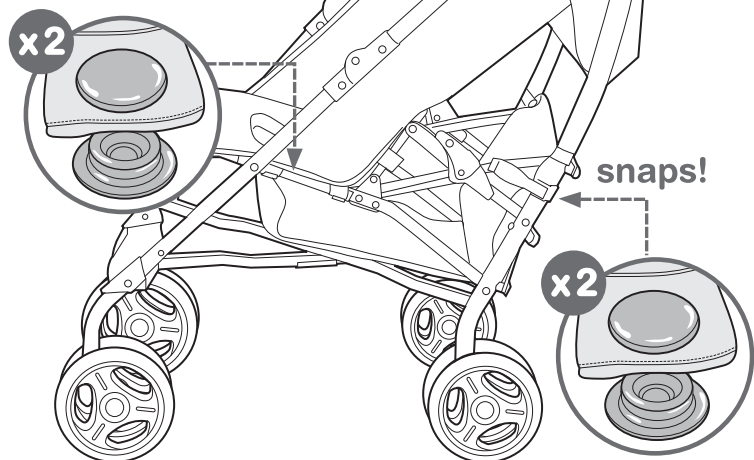

snaps!

- Clean minor stains on fabric with cold water and mild soap.
- Clean plastic and metal surfaces with a soft damp cloth. Air dry. Do not use abrasive cleaners or solvents. Do not use bleach.
- Check seat pad harness and crotch straps weekly to ensure they are properly secured to frame.

care and maintenance:



Summer Infant stands behind all of its products. If you are not completely satisfied or have any questions, please contact our Consumer Relations Team at 1-800-268-6237 or www.summerinfant.com/contact (For Europe call (0) 144 250 5000 or customerserviceuk@summerinfant.com)



©2014 Summer Infant, Inc.
Colors and styles may vary.
Please retain for future reference.

Summer Infant, Inc.
1275 Park East Drive
Woonsocket, RI 02895 USA
1-800-268-6237

Summer Infant Canada
200 First Gulf Blvd., Unit C
Brampton, Ontario, Canada, L6W 4T5
1-905-456-8484
MADE IN CHINA.

12/15



21840A, 21930A, 21960A, 21970A
21940A, 21990A, 21920A

3Dlite™

convenience stroller

INSTRUCTION MANUAL

Please read the following instructions and warnings carefully before using the stroller. Keep this instruction manual for future reference.

For Technical Support Call 1-800-268-6237
Keep small parts away from children.
No tools required.

WARNING:
Adult assembly required.
Exercise care when unpacking and assembling product.



Thank you for purchasing the 3Dlite convenience stroller by Summer Infant®. This product was proudly designed in the USA. If you have any trouble using this product, please call our Consumer Relations Team at 1-800-268-6237 before returning to the store. We're here to help! Happy strolling!

WARNING:

Read and follow all warnings and instructions.
Failure to do so could result in serious injury or death.

- Maximum weight and height of child: 50 lbs. (22.7 kg), 43" (109 cm)
- NEVER leave child unattended.
- Avoid serious injury from falling or sliding out. ALWAYS use safety harness.
- When making adjustments to the product ALWAYS ENSURE that all parts of a child's body are clear of any moving parts of the product.
- Care must be taken when folding and unfolding the product to prevent finger entrapment.
- DO NOT carry additional children, goods or accessories in or on this product except as recommended in the manufacturer's instructions.
- TO AVOID INJURY TO YOUR CHILD, DO NOT USE STORAGE BASKET AS A CHILD CARRIER.
- DO NOT hang items on handle bar or place them on the canopy, as they can tip stroller over and injure child.
- DO NOT OVERLOAD STORAGE BASKET. MAXIMUM 10 lbs. (4.5 kg).
- DO NOT overload the storage pocket and cup holder. MAXIMUM 2 lbs. (0.9 kg). Excessive weight may cause the stroller to become unstable or tip over.
- This product may become unstable if a parcel bag, other than the one recommended is used.
- Do not place hot liquids in the cup holder. Spills can burn your child.
- Do not carry or roll stroller on stairs or escalators with child in it.
- Do not use the strollers if any part is lost or damaged.
- See instructions for additional warnings.

components:

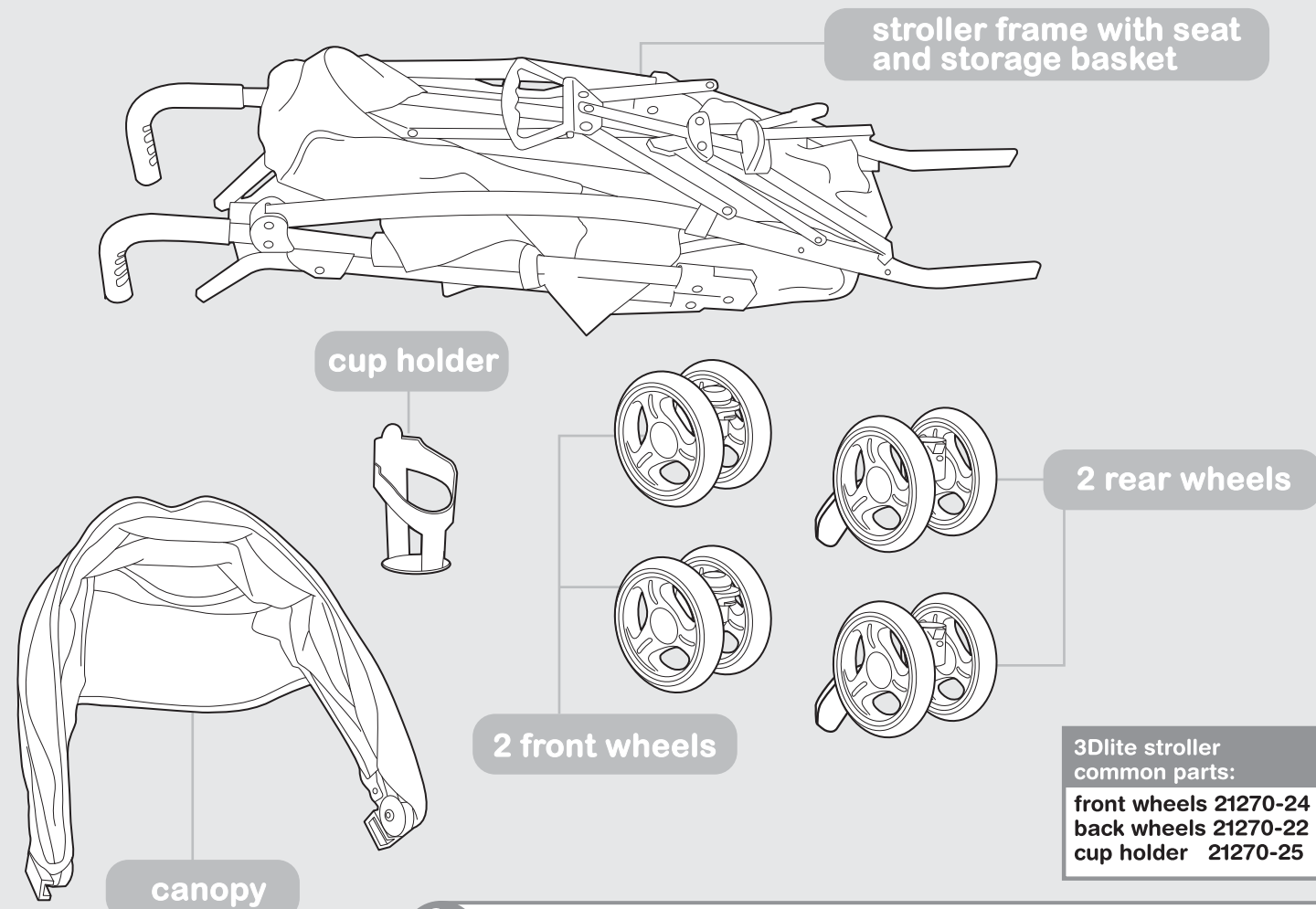

! IMPORTANT! Before assembly, inspect this product for damaged hardware, loose joints or missing parts. Never use if any parts are missing or broken.

assembly instructions:

- 1 lift up fold-lock to release
- 2 lift up to unfold

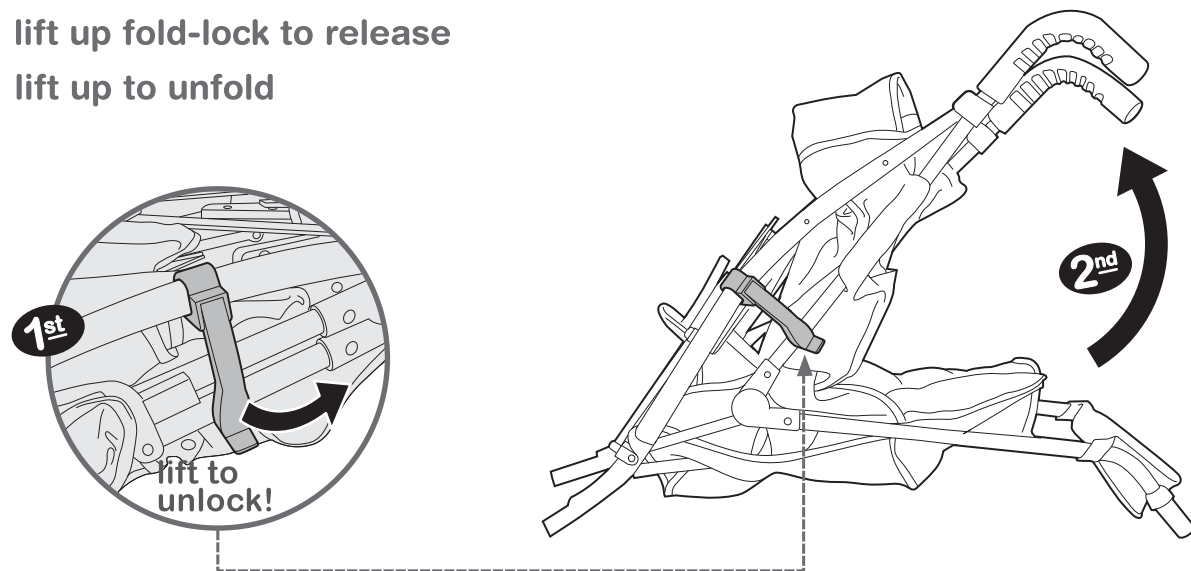

! NOTE: When opening the stroller, ensure that your child, or other children, are at a safe distance.

tightening and loosening the child restraint:

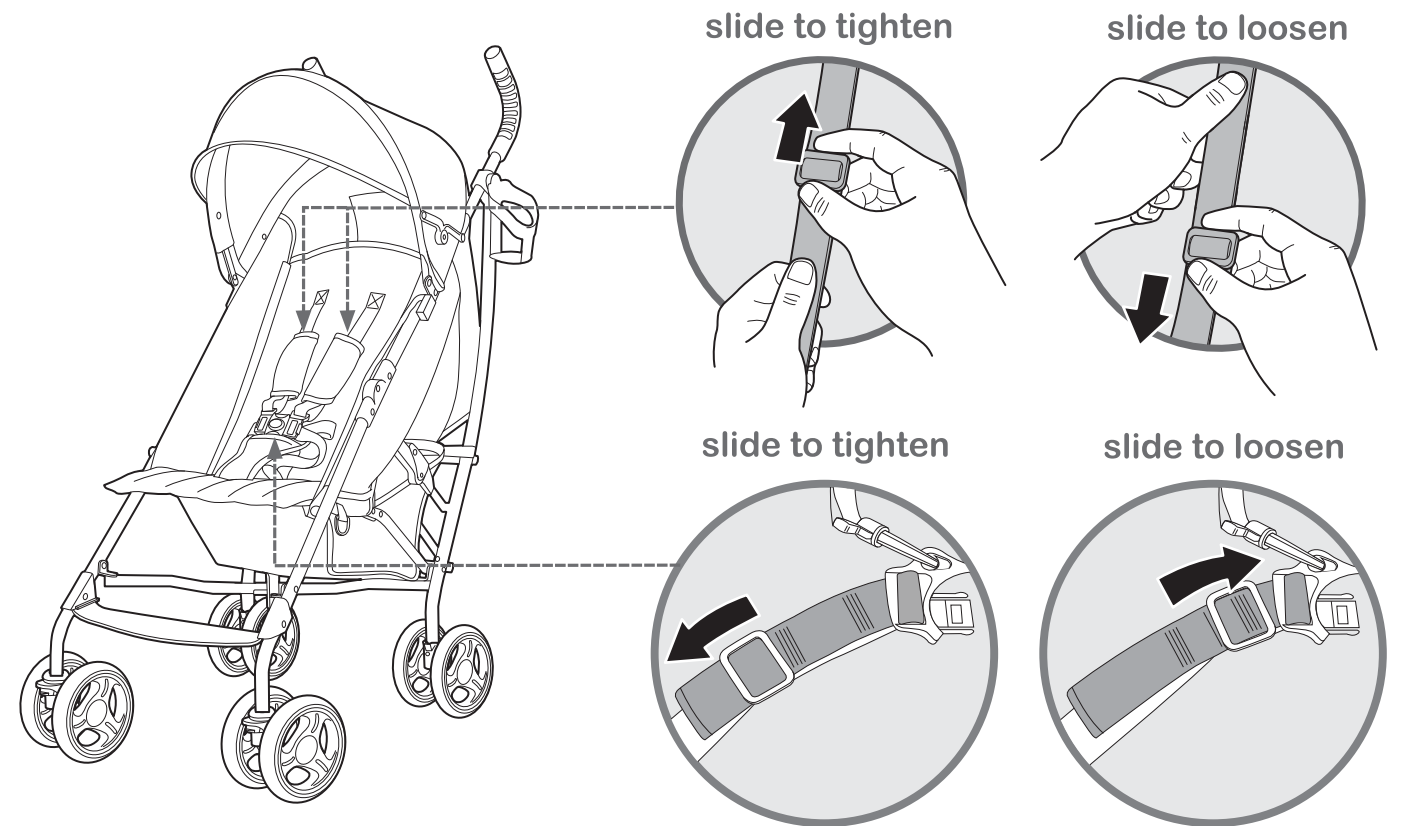

using the sun visor:

flip visor out as shown, tuck back under when not in use

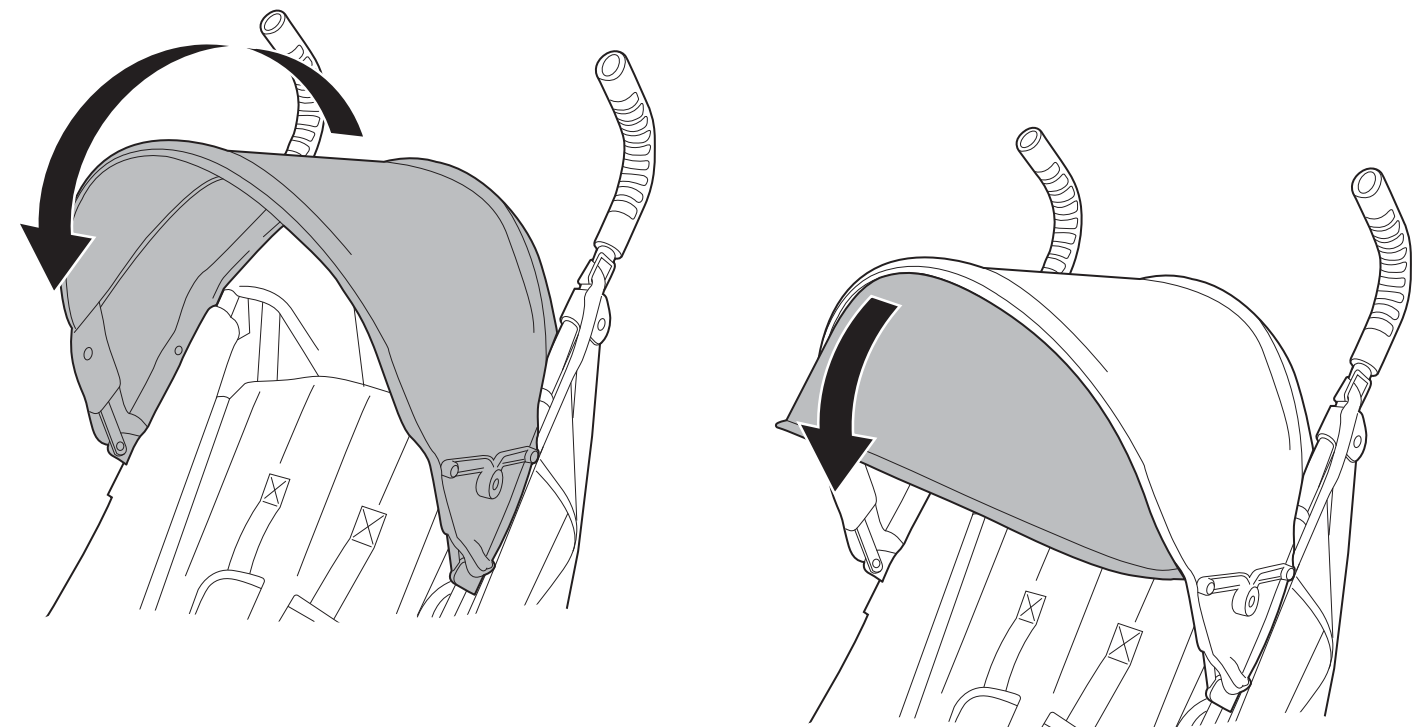

reclining the seat:

- 1 push seat forward to raise seat upright

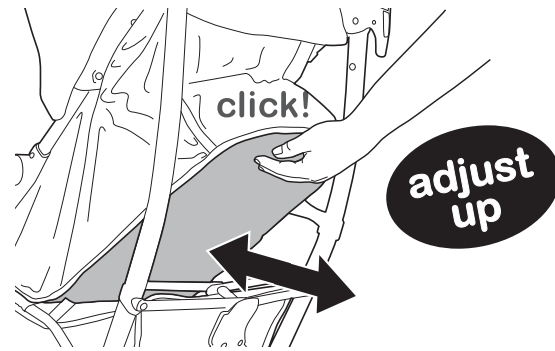

- 2 to lower backrest press red lever, lower backrest to desired position and lock in place

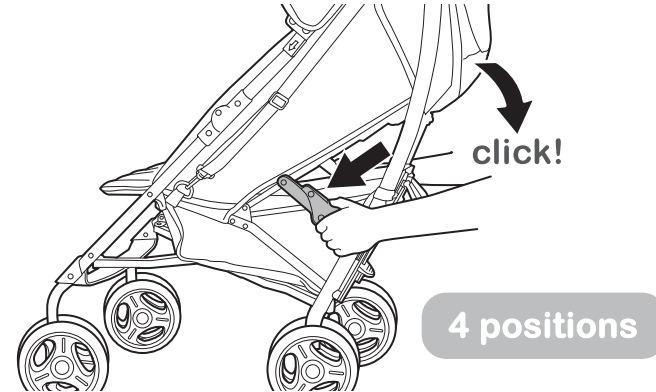

adjusting the shoulder harness position:

remove harness pads, unlock restraint, slide shoulder harness out of slot, and adjust harness position as shown below and reinstall harness pads.

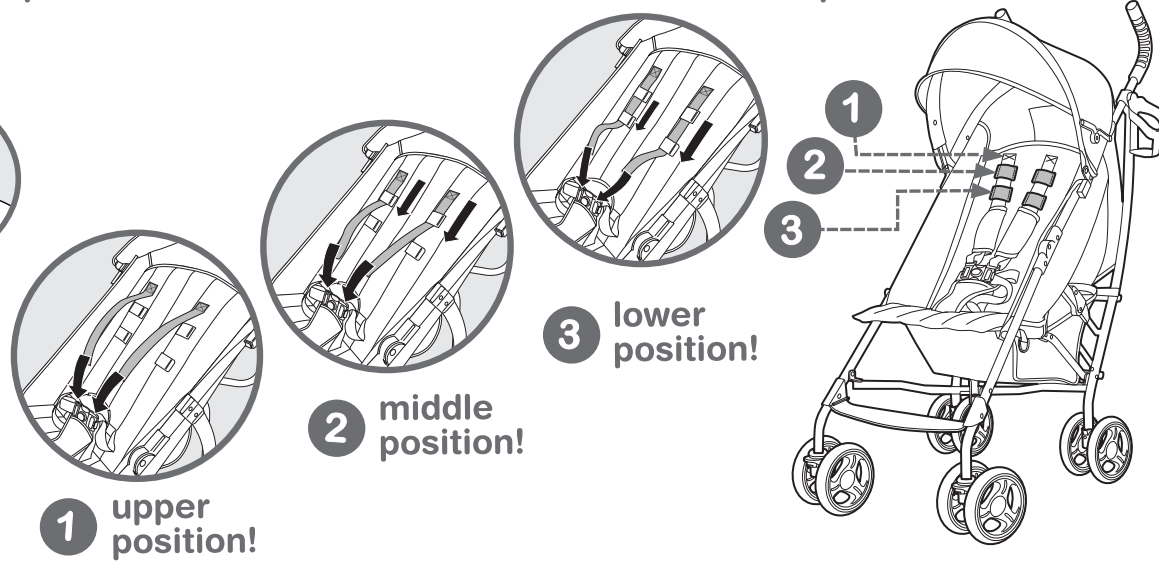
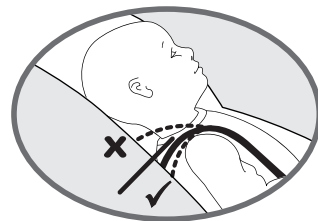

1 upper position!

2 middle position!

3 lower position!

locking/unlocking the child restraint:

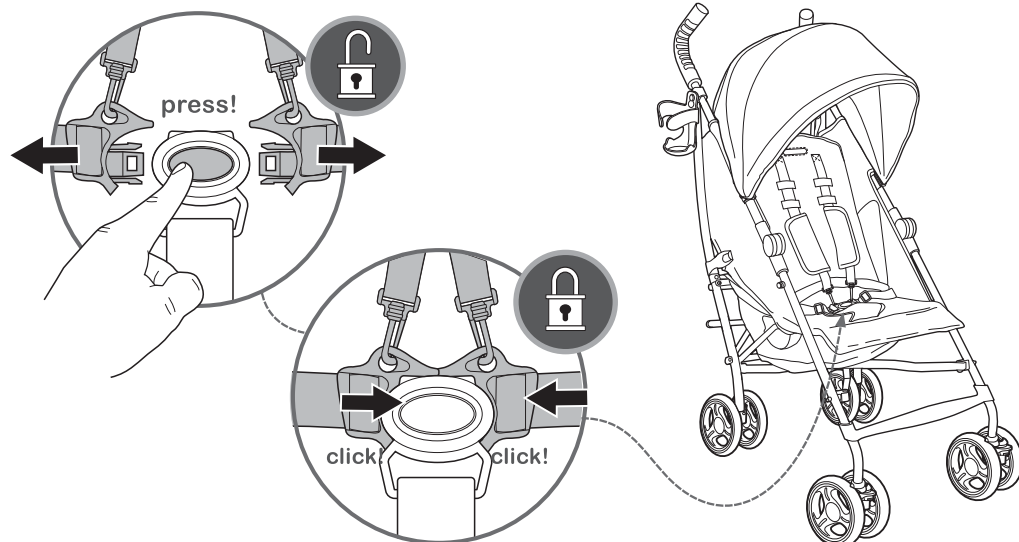

assembly instructions:

- 3 press the lock-out bar down with your foot

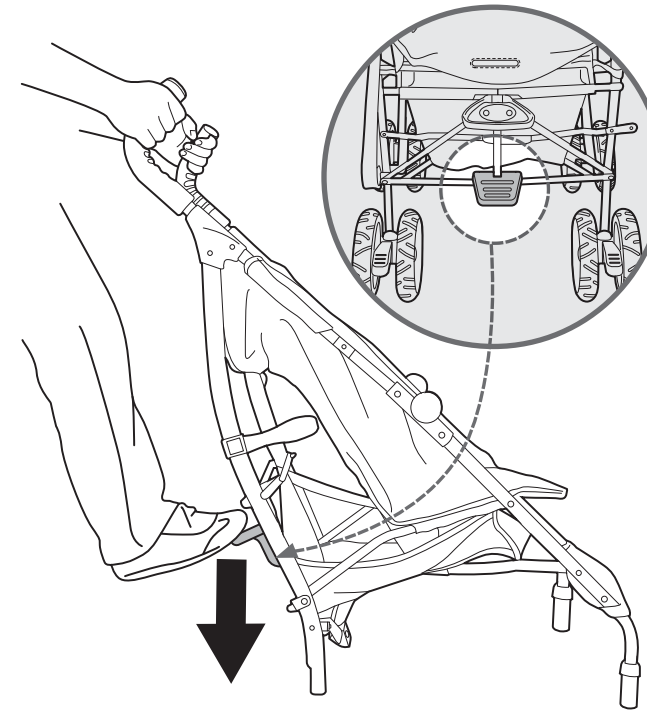

- 4 align rear wheels and push onto frame

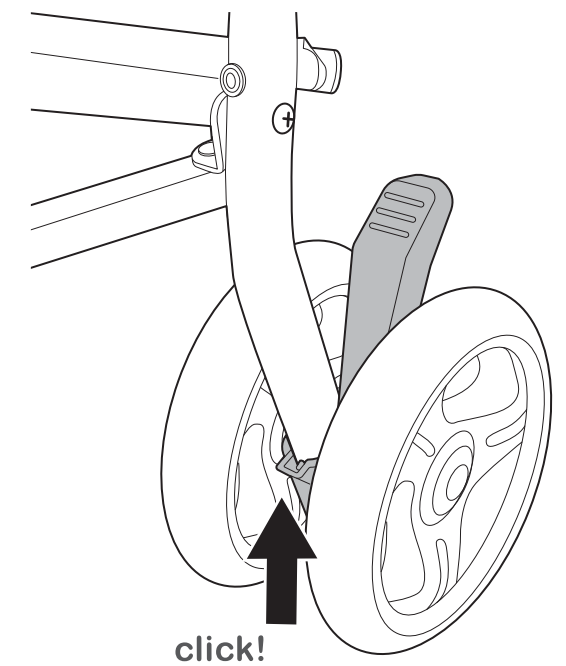

NOTE: Before use, ensure that the stroller locking mechanism is secured.

NOTE: Tug on each wheel to ensure they are both securely attached.

- 5 align front wheels making sure locations of lock pedal is up and push onto frame

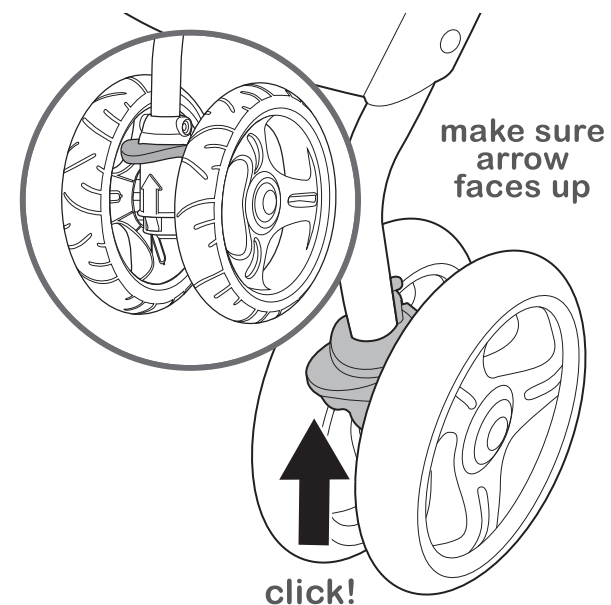

NOTE: Tug on each wheel to ensure they are both securely attached.

- 6 line up cupholder with mounting post and push down

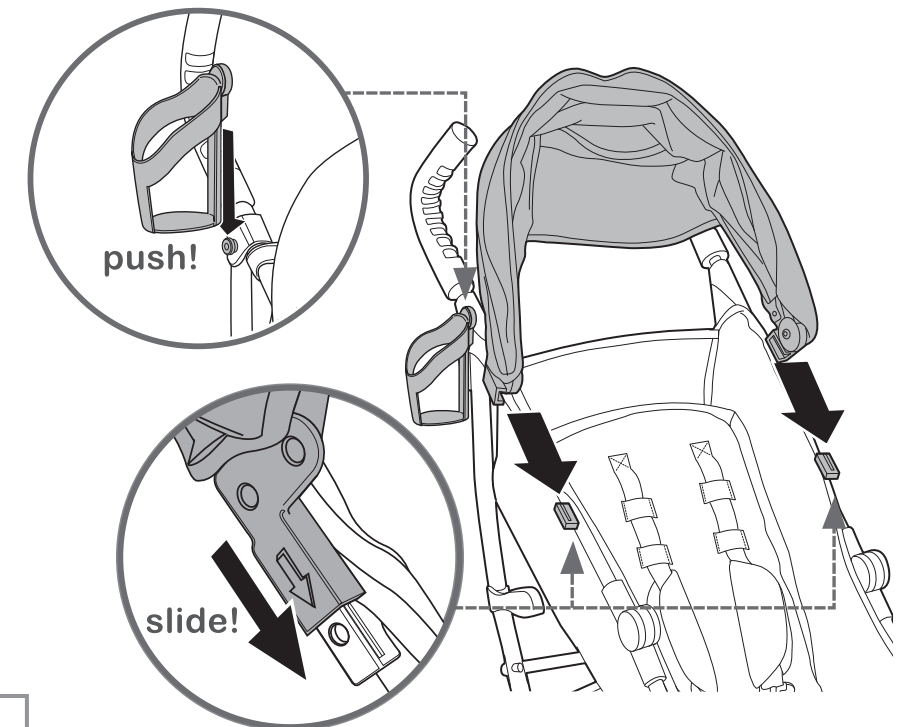

- 7 slide canopy onto frame mounts and attach velcro (both sides)

components:

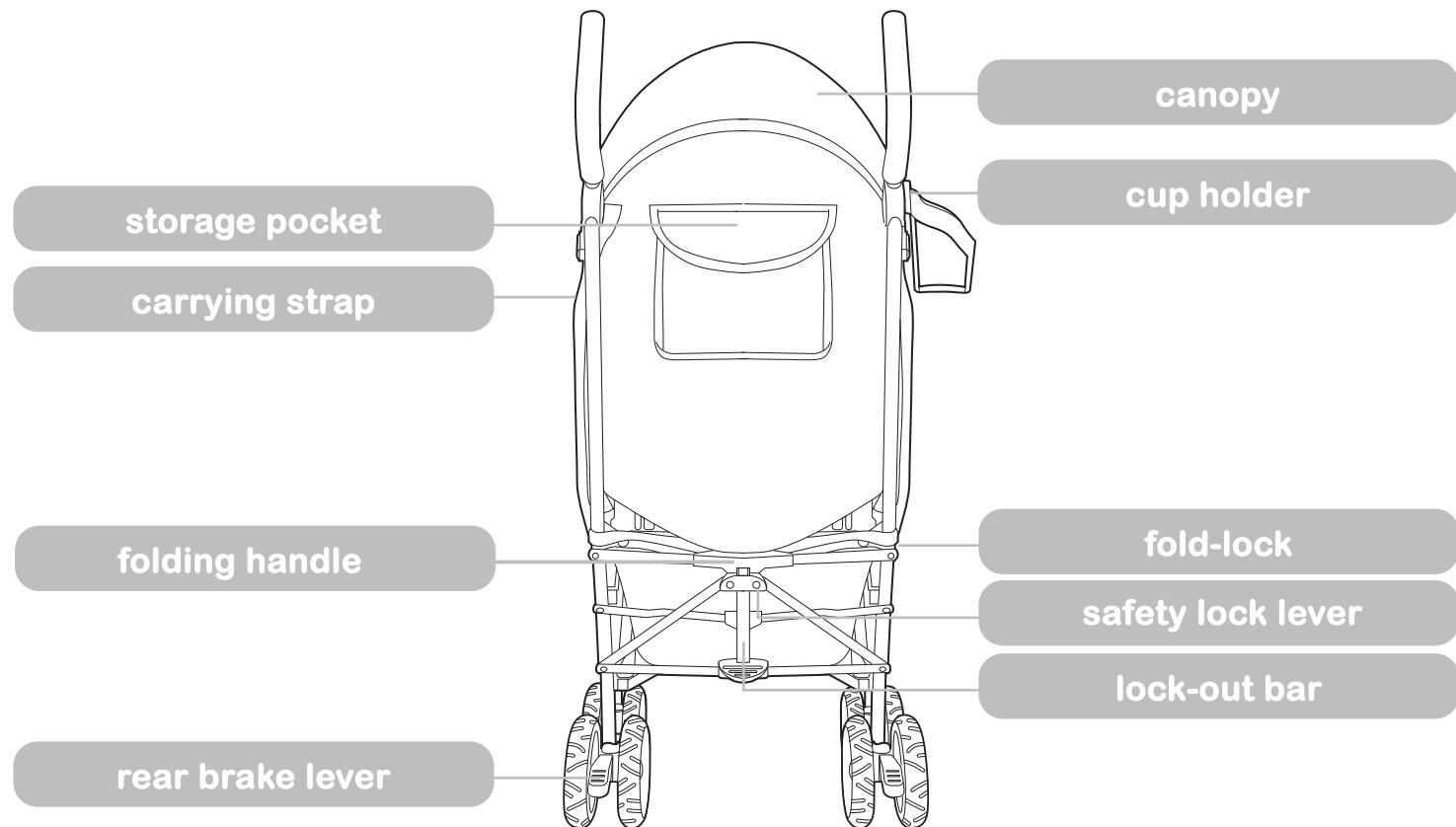
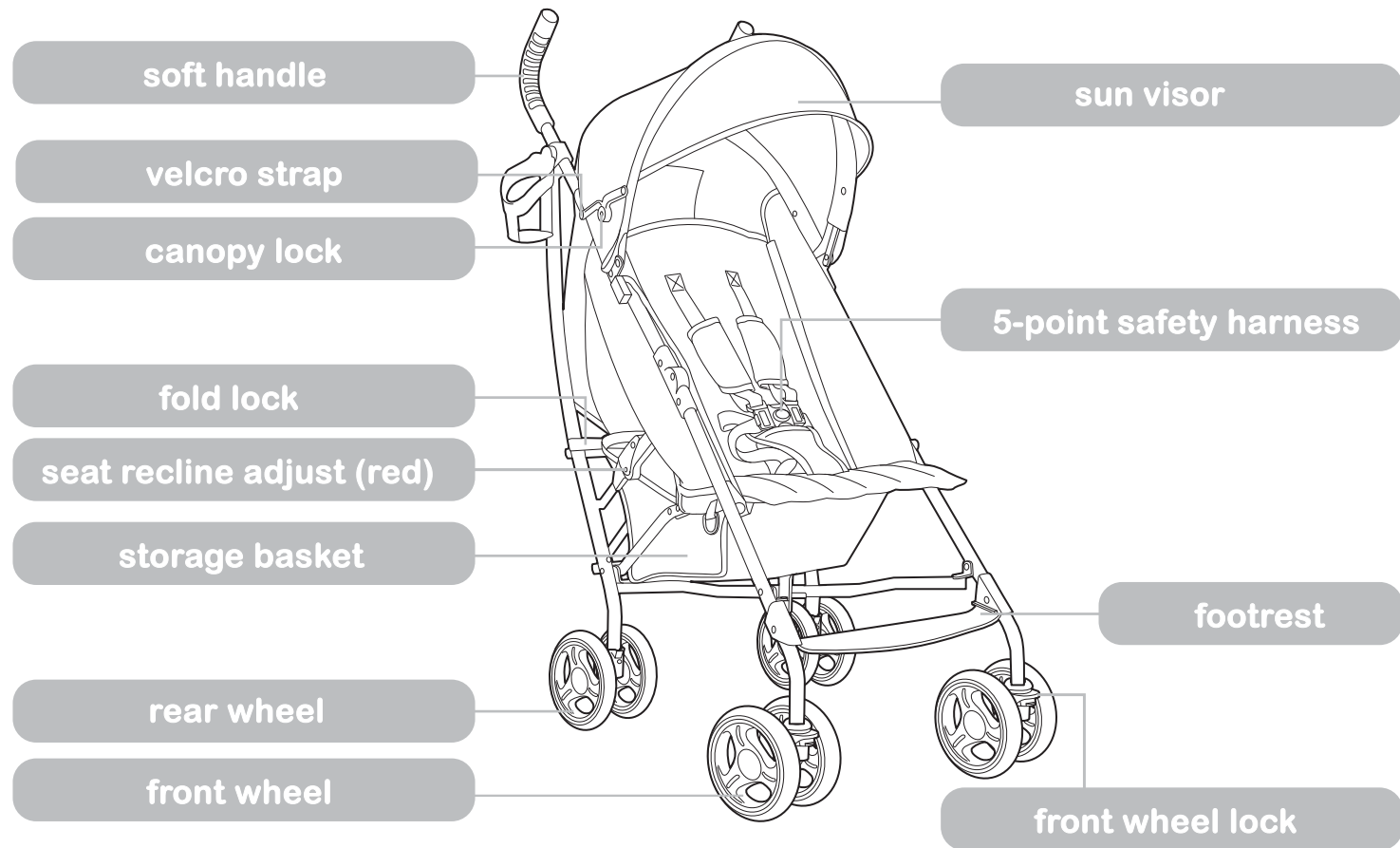

locking & unlocking the canopy:

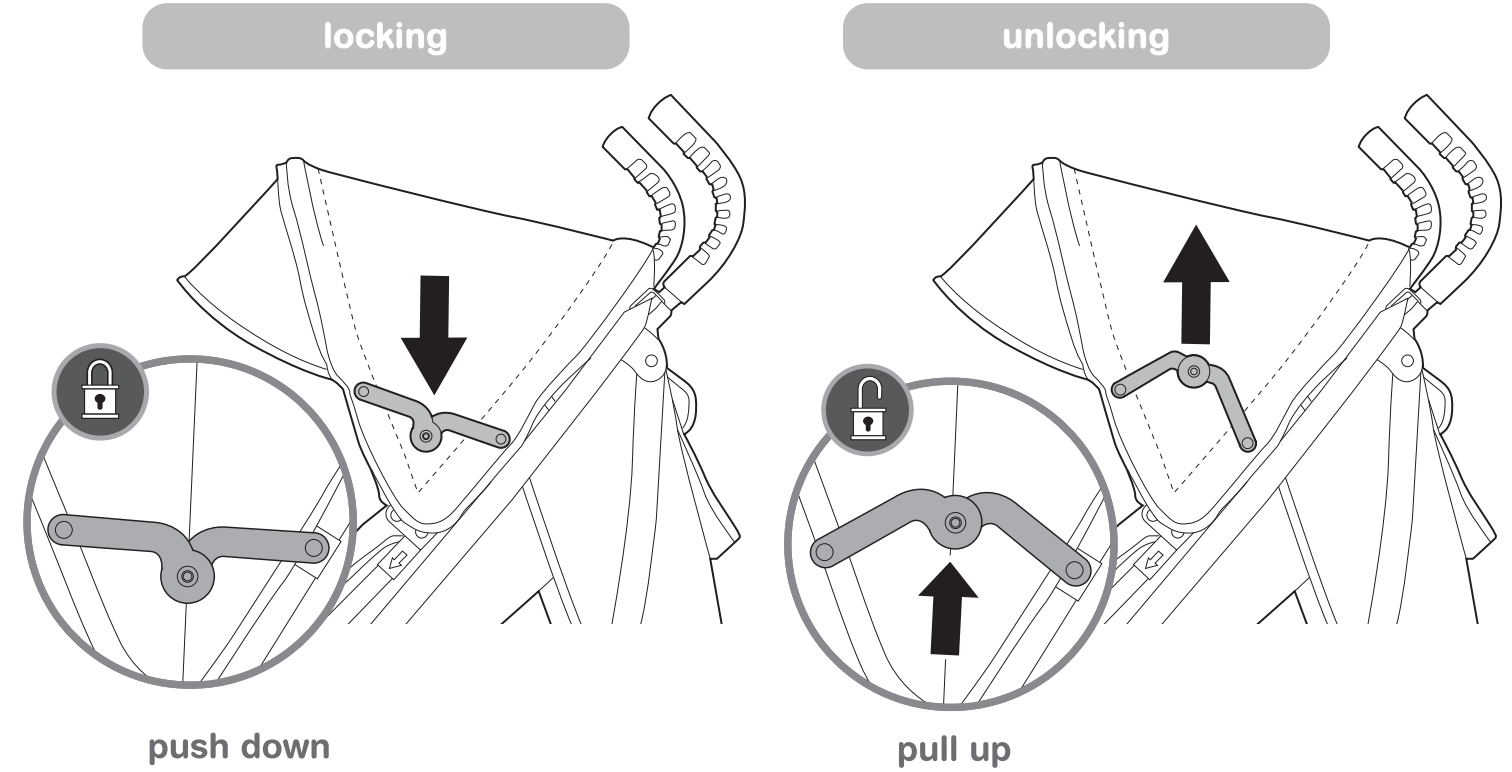

locking & unlocking the wheels:

