

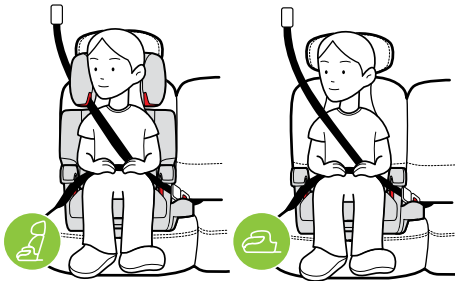

Oobr Instruction Manual

This belt-positioning booster seat (booster seat) is designed for use in either full back mode or backless mode by children who meet all of the following requirements:



Height	Weight	Recommended Age
--------	--------	-----------------

38–57 in. 96–145 cm.	33–100 lb. 15–45 kg.	4 years & up
-------------------------	-------------------------	--------------



Height	Weight	Recommended Age
--------	--------	-----------------

40–57 in. 101–145 cm.	40–100 lb. 18–45 kg.	4 years & up
--------------------------	-------------------------	--------------



WARNING

- **READ AND UNDERSTAND PRODUCT LABELS AND ALL INSTRUCTIONS IN THIS MANUAL AND IN YOUR VEHICLE OWNER'S MANUAL BEFORE INSTALLING OR USING THIS BOOSTER SEAT.**
- **FAILURE TO PROPERLY INSTALL OR USE THIS BOOSTER SEAT OR FOLLOW THESE WARNINGS AND THOSE ON THIS BOOSTER SEAT'S LABELS CAN RESULT IN SERIOUS INJURY OR DEATH TO THE CHILD IN A SHARP TURN, SUDDEN STOP OR CRASH.**

Checklist for Proper Use

IMPORTANT: This is only a checklist — you must read and understand all of the warnings and instructions on this booster seat's labels and in this manual before installing or using this booster seat.



When Using This Booster Seat in Full Back Mode (with Seat Back)

- ✓ Child weighs between 33 and 100 lb. (15 and 45 kg.), height is between 38 and 57 in. (96 to 145 cm.)
- ✓ Recommended that child is at least 4 years of age, (but NEVER before 3 years of age)
- ✓ Child is sitting in the booster seat in a forward-facing location in the vehicle rear seat
- ✓ Vehicle seat belt is correctly routed beneath Armrests and through the Shoulder Belt Guide
- ✓ There is no slack in the vehicle seat belt
- ✓ Vehicle lap belt sits low and snugly on the child's hips and is not twisted. The shoulder belt **MUST** be at or above the child's shoulder, lie snugly across the midpoint of the child's chest and across the center of the shoulder, and **MUST** not be twisted
- ✓ Child is sitting upright and is not slouching
- ✓ The tops of the child's ears are below the top of the booster seat Headrest
- ✓ Booster seat is securely installed with both LATCH Connectors attached to vehicle's LATCH lower anchors, if available



When Using This Booster Seat in Backless Mode (without Seat Back)

- ✓ Child weighs between 40 and 100 lb. (18 and 45 kg.), height is between 40 and 57 in. (101 to 145 cm.) and is at least 4 years of age
- ✓ Child is at least 4 years of age
- ✓ Child is sitting in the booster seat in a forward-facing location in the vehicle rear seat
- ✓ Vehicle seat belt is correctly routed beneath Armrests and shoulder belt is properly positioned on child's shoulder
- ✓ There is no slack in the vehicle seat belt
- ✓ Vehicle lap belt sits low and snugly on the child's hips and is not twisted. The shoulder belt **MUST** be at or above the child's shoulder, lie snugly across the midpoint of the child's chest and across the center of the shoulder, and **MUST** not be twisted
- ✓ Child is sitting upright and is not slouching
- ✓ The tops of the child's ears are below the top of the vehicle seat back or headrest in its highest adjustment position
- ✓ Booster seat is securely installed with both LATCH Connectors attached to vehicle's LATCH lower anchors, if available

Table of Contents

Checklist for Proper Use	i
When Using This Booster Seat in Full Back Mode (with Seat Back)	i
When Using This Booster Seat in Backless Mode (without Seat Back)	ii
Booster Seat Features	3
Registration & Recall Information	4
Registering Your Booster Seat	5
Warnings	6
Certification	9
Size & Age Limitations	10
When Using This Booster Seat in Full Back Mode (with Seat Back)	10
When Using This Booster Seat in Backless Mode (without Seat Back)	12
Vehicle Information	13
Vehicle Child Restraint Anchorage System (LATCH)	13
Vehicle Seat Location Requirements	14
Vehicle Seat Belt Requirements	15
Unsafe Vehicle Seat Belt Systems	16
Installing/Removing Booster Seat Using LATCH Connectors	17
Installing Booster Seat in Full Back Mode When Using LATCH Connectors	18
Adjusting the Seat Back Recline	23
Removing Booster Seat in Full Back Mode When Using LATCH Connectors	25
Installing Booster Seat in Backless Mode When Using LATCH Connectors	26
Removing Booster Seat in Backless Mode When Using LATCH Connectors	32

Installing Booster Seat WITHOUT Using LATCH Connectors	33
Installing Booster Seat in Full Back Mode WITHOUT Using LATCH Connectors	34
Installing Booster Seat in Backless Mode WITHOUT Using LATCH Connectors	36
Securing Your Child in Booster Seat	38
When Using Booster Seat in Full Back Mode (with Seat Back)	39
Adjusting the Headrest	46
When Using Booster Seat in Backless Mode (without Seat Back)	47
Installing/Removing Seat Back	53
Installing/Removing Cup Holder (drink-thingy™)	56
Instruction Manual Storage	57
Care & Cleaning	58
Removing/Installing Seat Cushion & Seat Cushion Cover	58
Washing Instructions	62
Seat Cushion Cover Washing Instructions	62
Seat Back Cover & Headrest Cover Fabric Washing Instructions	63
Seat Frame (Exterior Plastics Only) Washing Instructions	64
Accessories	64
Warranty	65

For concerns related to parts or the use and maintenance of this product, please contact us at:

Clek Inc.
12 Upjohn Rd., Suite 1
Toronto, Ontario Canada
M3B 2V9
www.clekinc.com

Booster Seat Features

- | | |
|---|--|
| 1 LATCH Connectors | 10 Instruction Manual
(store in compartment under seat) |
| 2 Recline Handle | 11 Lap Belt Guides |
| 3 Seat Cushion | 12 Shoulder Belt Guides |
| 4 Cup Holder (drink-thingy™) | 13 Seat Base |
| 5 Armrests | |
| 6 Seat Back Release Strap
(to remove Seat Back for
backless mode) | |
| 7 Seat Back
(for full back mode) | |
| 8 Headrest | |
| 9 Headrest Adjuster | |

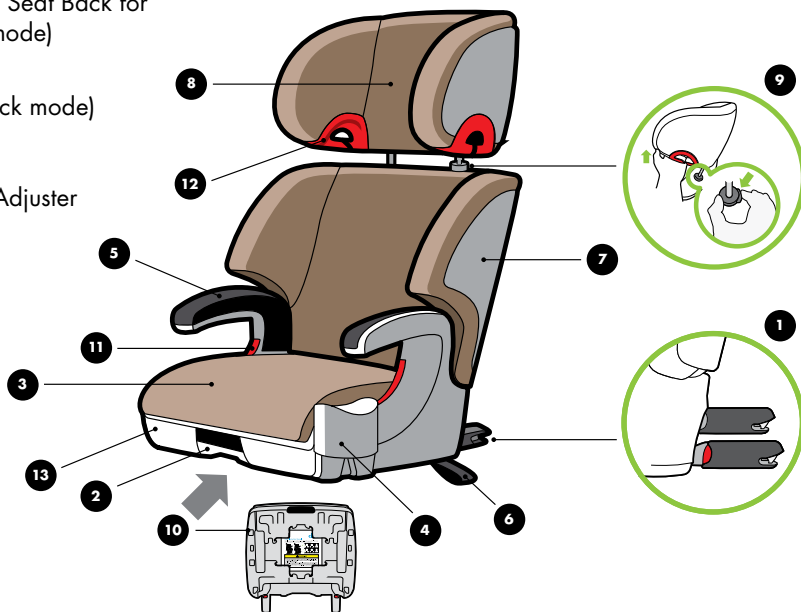

Registration & Recall Information

WARNING

- CHILD RESTRAINTS COULD BE RECALLED FOR SAFETY REASONS. YOU MUST REGISTER THIS RESTRAINT (BOOSTER SEAT) TO BE REACHED IN A RECALL.

Model Name: **Oobr** _____

Serial Number: _____

Manufactured In: _____
(yyyy/mm/dd)

Date of Purchase: _____

Registering Your Booster Seat

Please fill in the information on the previous page for your records. The model name, serial number and manufacturing date can be found on a label affixed to the underside of this booster Seat Base.

Fill out the prepaid registration postcard attached to the seat and mail it today.

Child restraints could be recalled for safety reasons. You **MUST** register this restraint (booster seat) to be reached in a recall. Send your name, address, e-mail address if available, and the restraint's model number and manufacturing date to Clek Inc., 12 Upjohn Rd., Suite 1, Toronto, Ontario, Canada M3B 2V9, or call Clek Inc's customer service line at 1-866-656-2462 to register, or you may register online at <http://www.clekinc.com/register>. For recall information, call the U.S. Government's Vehicle Safety Hotline at 1-888-327-4236 (TTY: 1-800-424-9153), or go to <http://www.NHTSA.gov>.

Warnings

WARNING – DEATH or SERIOUS INJURY can occur

FAILURE TO PROPERLY INSTALL OR USE THIS BOOSTER SEAT OR FOLLOW THESE WARNINGS AND INSTRUCTIONS AND THOSE ON THIS BOOSTER SEAT'S LABELS CAN RESULT IN SERIOUS INJURY OR DEATH OF THE CHILD IN A SHARP TURN, SUDDEN STOP OR CRASH.

- DO NOT INSTALL OR USE THIS BOOSTER SEAT UNTIL YOU READ AND UNDERSTAND THE INSTRUCTIONS IN THIS MANUAL AND IN YOUR VEHICLE OWNER'S MANUAL. DO NOT LET OTHERS INSTALL OR USE THIS BOOSTER SEAT UNLESS THEY UNDERSTAND HOW TO CORRECTLY INSTALL AND USE IT.
- THIS BOOSTER SEAT MUST BE INSTALLED BY AN ADULT.
- NEVER ALLOW THE CHILD TO BUCKLE THEMSELVES IN THIS BOOSTER SEAT.
- FAILURE TO CHOOSE THE CORRECT BOOSTER SEAT MODE (FULL BACK OR BACKLESS) AND TO PROPERLY SECURE YOUR CHILD CAN INCREASE THE RISK OF INJURY OR DEATH.
- USE ONLY THE VEHICLE'S LAP AND SHOULDER BELT SYSTEM WHEN RESTRAINING THE CHILD IN THIS BOOSTER SEAT.

 **WARNING – DEATH or
SERIOUS INJURY can occur (continued)**

- NEVER USE WITH ONLY A LAP BELT TO RESTRAIN A CHILD IN THIS BOOSTER SEAT. USE WITHOUT A LAP AND SHOULDER BELT CAN RESULT IN SERIOUS INJURY OR DEATH.
- DO NOT USE THIS BOOSTER SEAT WITH MOTORIZED OR DOOR MOUNTED BELT SYSTEMS.
- SECURE THIS CHILD RESTRAINT WITH THE VEHICLE'S CHILD RESTRAINT ANCHORAGE SYSTEM IF AVAILABLE OR WITH A VEHICLE BELT.
- DO NOT USE THIS BOOSTER SEAT AFTER AN ACCIDENT OF ANY KIND. AN ACCIDENT CAN CAUSE DAMAGE TO THIS BOOSTER SEAT THAT YOU CANNOT SEE.
- DO NOT USE THIS BOOSTER SEAT AFTER NINE (9) YEARS FROM THE DATE OF MANUFACTURE. THE DATE OF MANUFACTURE CAN BE FOUND ON THE LABEL AFFIXED TO THE UNDERSIDE OF THE BOOSTER SEAT CUSHION BASE.
- DO NOT ATTEMPT TO MAKE REPAIRS TO OR OTHERWISE MODIFY OR TAMPER WITH THIS BOOSTER SEAT.
- NEVER USE THIS BOOSTER SEAT IF IT IS DAMAGED OR HAS MISSING PARTS.

 **WARNING – DEATH or
SERIOUS INJURY can occur (continued)**

- DO NOT USE ACCESSORIES OR PARTS WITH THIS BOOSTER SEAT OTHER THAN THOSE PROVIDED BY CLEK INC. USE OF ACCESSORIES OR PARTS FROM OTHER MANUFACTURERS COULD ALTER THE PERFORMANCE OF THIS BOOSTER SEAT.
- AVOID BURN INJURY – ALWAYS TOUCH THE SURFACES OF THE PARTS FIRST BEFORE PUTTING THE CHILD IN THIS BOOSTER SEAT. THIS BOOSTER SEAT CAN BECOME VERY HOT IF LEFT IN THE SUN AND CAN BURN THE CHILD'S SKIN.
- KEEP THIS MANUAL IN THE STORAGE COMPARTMENT LOCATED ON THE BOTTOM OF THIS BOOSTER SEAT FOR FUTURE USE.
- NEVER USE A SECOND-HAND BOOSTER SEAT OR A BOOSTER SEAT WHOSE HISTORY YOU DO NOT KNOW.
- REGISTER YOUR BOOSTER SEAT WITH CLEK INC.

Certification

- This booster seat conforms to all applicable Federal Motor Vehicle Safety Standards and is certified for use in motor vehicles.
- **This booster seat is not certified for aircraft use because aircraft seats DO NOT have shoulder belts.**

Size & Age Limitations

WARNING

- FAILURE TO CHOOSE THE CORRECT BOOSTER SEAT MODE (FULL BACK OR BACKLESS) FOR YOUR CHILD'S HEIGHT AND WEIGHT MAY INCREASE THE RISK OF INJURY OR DEATH.

The child **MUST** meet ALL of the following requirements on page 10 through page 12 to use this booster seat:



When Using This Booster Seat in Full Back Mode (with Seat Back)

- Child's weight is between 33 and 100 lb. (15 and 45 kg.), AND
- Child's height is between 38 and 57 in. (96 and 145 cm.), AND
- Recommended that child is at least 4 years of age (but NEVER before 3 years of age)

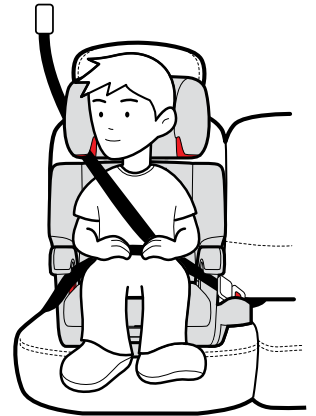

- The tops of the child's ears **MUST** be below the top of this booster seat's Headrest, as shown in **Figure 1**. If the tops of the ears are above the top of this booster seat's Headrest in the highest adjustment position, your child is too large for using this booster seat in full back mode.



Figure 1

- The Shoulder Belt Guide **MUST** be at or above the child's shoulder, as shown in **Figure 2**. If the child's shoulder is above the Shoulder Belt Guide with the Headrest in its highest adjustment position, your child is too large for using this booster seat in full back mode.

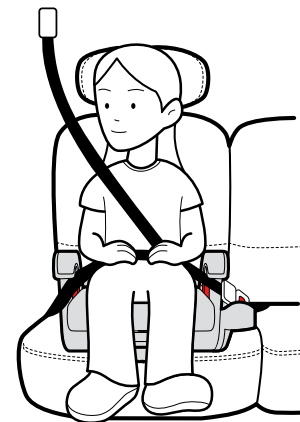

Figure 2



When Using This Booster Seat in Backless Mode (without Seat Back)

- Child's weight is between 40 and 100 lb. (18 and 45 kg.), AND
- Child's height is between 40 and 57 in. (101 and 145 cm.), AND
- Child is at least 4 years of age, AND



- The tops of the child's ears **MUST** be below the top of the vehicle seat back or the vehicle seat's headrest in the highest adjustment position, as shown in **Figure 3**. If the tops of the child's ears are above the top of the vehicle seat back or headrest in the highest adjustment position, your child is too large for using this booster seat in backless mode.



Figure 3

Vehicle Information

Vehicle Child Restraint Anchorage System (LATCH)

- LATCH stands for Lower Anchors and Tethers for Children. These terms refer to the anchors built into a vehicle for attaching child restraints and consists of two lower anchors at the crease between the vehicle seat back and vehicle seat cushion and a top tether anchor behind the vehicle seat. The Clek booster seat has been designed to attach securely to only the vehicle's LATCH lower anchors.
- 2003 model year vehicles or newer have at least two seating locations with a LATCH Anchorage System. Some 2001 and 2002 model year vehicles have LATCH Anchorage Systems. 2000 model year vehicles or older DO NOT have LATCH Anchorage Systems. See your vehicle owner's manual or visit www.clekinc.com if you are unsure if your vehicle is equipped with a LATCH Anchorage System.
- The LATCH lower anchors are located in the crease between the vehicle seat back and vehicle seat cushion, as shown in **Figure 4**.
- If not readily visible, the LATCH lower anchors may be noted by a symbol located near the crease between the vehicle seat back and vehicle seat cushion, as shown in **Figure 5**.

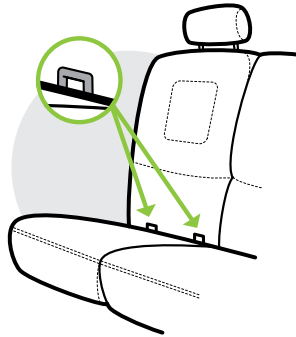

Figure 4

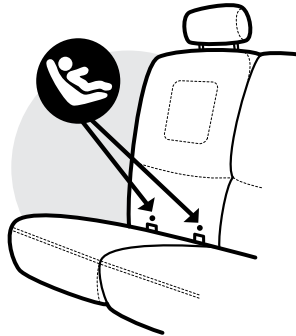

Figure 5

Vehicle Seat Location Requirements

WARNING

- ACCORDING TO ACCIDENT STATISTICS, CHILDREN ARE SAFER WHEN PROPERLY RESTRAINED IN REAR VEHICLE SEATING POSITIONS, RATHER THAN FRONT SEATING POSITIONS.
- IMPROPER PLACEMENT OF THIS BOOSTER SEAT IN YOUR VEHICLE INCREASES THE RISK OF SERIOUS INJURY OR DEATH. SOME SEATING POSITIONS IN YOUR VEHICLE MAY NOT BE SAFE FOR THIS BOOSTER SEAT. SOME VEHICLES DO NOT HAVE ANY SEATING POSITIONS THAT CAN BE USED SAFELY WITH THIS BOOSTER SEAT. IF YOU ARE NOT SURE WHERE TO PLACE THIS BOOSTER SEAT IN YOUR VEHICLE, CONSULT YOUR VEHICLE OWNER'S MANUAL OR CALL 1-866-656-2462.

Before using this booster seat please reference your vehicle owner's manual for information about air bags and booster seat use.

NEVER use this booster seat in a front vehicle seat location, as shown in **Figure 6**, unless recommended by your vehicle owner's manual,

Whenever possible secure this booster seat in the center position of the seat directly behind the front seats. However, this position is sometimes equipped with a lap belt only and cannot be used with this booster seat.



Figure 6

Install this booster seat only on vehicle seats that face forward. NEVER install this booster seat on vehicle seats facing sideways or backwards, as shown in **Figure 7**.



Figure 7

Only use this booster seat on vehicle seats with seat backs that lock in an upright position. Check that the vehicle seat back is locked in the upright position.

Vehicle Seat Belt Requirements

WARNING

- USE ONLY THE VEHICLE'S LAP AND SHOULDER BELT SYSTEM WHEN RESTRAINING THE CHILD IN THIS BOOSTER SEAT.
- NEVER USE THIS BOOSTER SEAT WITH A VEHICLE SEAT BELT THAT IS CUT, DAMAGED, FRAYED OR INOPERABLE.
- USING THIS BOOSTER SEAT WITH AN UNSAFE VEHICLE SEAT BELT SYSTEM CAN RESULT IN SERIOUS INJURY OR DEATH. PAY CAREFUL ATTENTION TO THESE SYSTEMS; SOME OF THE SEAT BELTS THAT ARE NOT SAFE TO USE LOOK VERY MUCH LIKE SEAT BELTS THAT ARE SAFE TO USE. IF YOU ARE UNSURE, CONSULT YOUR VEHICLE OWNER'S MANUAL OR CALL 1-866-656-2462.

UNSAFE VEHICLE SEAT BELT SYSTEMS

DO NOT USE ANY OF THE FOLLOWING VEHICLE SEAT BELT SYSTEMS WITH THIS BOOSTER SEAT:

- NEVER use a lap-only belt, as shown in **Figure 8**.



Figure 8

- NEVER use a passive restraint — lap or shoulder belt mounted on door, as shown in **Figure 9**.



Figure 9

- NEVER use a passive restraint — lap belt with a motorized shoulder belt, as shown in **Figure 10**.



Figure 10

Installing/Removing Booster Seat Using LATCH Connectors

IMPORTANT: This booster seat is designed to be used with the vehicle's LATCH Anchorage System. Always secure this booster seat to the vehicle's LATCH Anchorage System, if available. If your vehicle does not have a LATCH Anchorage System, you can still use this booster seat. See "Installing Booster Seat WITHOUT Using LATCH Connectors" section of this manual on page 33.

WARNING

- FAILURE TO PROPERLY INSTALL OR USE THIS BOOSTER SEAT INCREASES THE RISK OF SERIOUS INJURY OR DEATH TO THE CHILD AND OTHERS IN A SHARP TURN, SUDDEN STOP OR CRASH.
- TO AVOID INJURY THIS BOOSTER SEAT MUST BE INSTALLED BY AN ADULT.
- NEVER LEAVE THIS BOOSTER SEAT UNSECURED IN YOUR VEHICLE. THIS BOOSTER SEAT MUST REMAIN CONNECTED TO THE LATCH LOWER ANCHORS IN THE VEHICLE OR SECURED BY THE VEHICLE'S SEAT BELT EVEN WHEN NOT IN USE. IN A SHARP TURN, CRASH OR SUDDEN STOP, AN UNSECURED BOOSTER SEAT CAN BE THROWN AROUND AND COULD SEVERELY INJURE VEHICLE OCCUPANTS.



Installing Booster Seat in Full Back Mode When Using LATCH Connectors

To install Seat Back, see "Installing/Removing Seat Back" section of this manual on page 53.

Step 1.

Select a forward-facing vehicle seating location which has a lap and shoulder belt and LATCH Anchorage System.

If the vehicle seat back is adjustable, make sure the seat back is locked in the upright position. DO NOT allow the child to sit in this booster seat while the vehicle seat back is reclined, as shown in **Figure 11**.

Locate the LATCH lower anchors (as explained in the "Vehicle Child Restraint Anchorage System (LATCH)" section of this manual and in your vehicle owner's manual).



Figure 11

⚠ WARNING

- DO NOT USE THE LATCH CONNECTORS TO SECURE THIS BOOSTER SEAT TO THE VEHICLE'S LATCH ANCHORAGE SYSTEM IF THE SEAT BELT OR SEAT BELT BUCKLE IS NOT EASILY ACCESSIBLE WITH THIS BOOSTER SEAT LATCHED IN PLACE OR IF THE VEHICLE SEAT BELT BUCKLE IS LOCATED IN BETWEEN THE LATCH ANCHORS, AS SHOWN IN **FIGURE 12**. OR IF THE VEHICLE SEAT BELT IS LOCATED IN BETWEEN THE LATCH ANCHORS, AS SHOWN IN **FIGURE 13**.

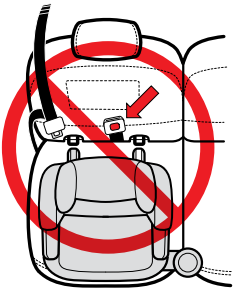

Figure 12

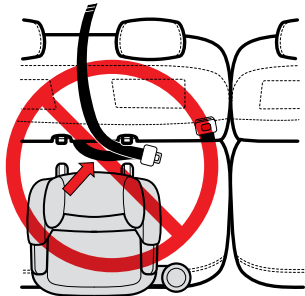

Figure 13

To connect to lower anchors, pull and hold Recline Handle on front of booster Seat Base ① and pull LATCH Connectors out ②, as shown in **Figure 14**. Release Recline Handle.

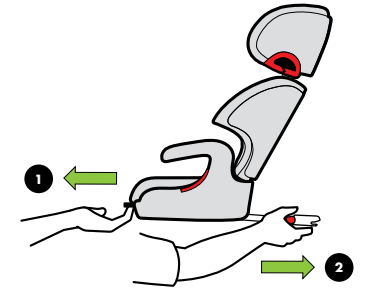

Figure 14

Step 2.

Place booster in the seating location selected with the LATCH Connectors facing the vehicle seat.

Secure the LATCH Connectors to the vehicle LATCH lower anchors by aligning the LATCH Connectors with the vehicle LATCH anchors and pressing the LATCH Connectors against the LATCH lower anchors until you hear each LATCH Connector click, as shown in **Figure 15**.

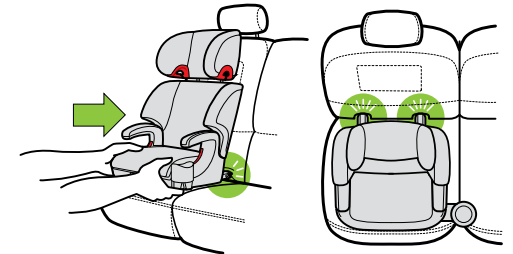

Figure 15

IMPORTANT: If LATCH Connectors fail to connect to the vehicle's LATCH lower anchors, you can still use this seat. See "Installing Booster Seat in Full Back Mode WITHOUT Using LATCH Connectors" section of this manual on page 34. **Please notify Clek Customer Service if the LATCH Connectors fail to latch by calling 1-866-656-2462.**

Step 3.

Once the LATCH Connectors are connected to the LATCH lower anchors, pull forward on this booster seat to make sure it is securely attached to the vehicle's LATCH lower anchors on both sides. If not, start over at **Step 1**.

Step 4.

Complete installation by adjusting this booster seat so the back of this booster seat contacts the front of the vehicle seat back or headrest, as shown in **Figure 16**.

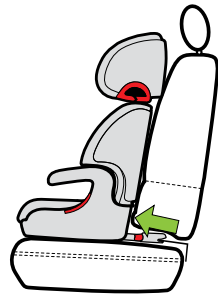

Figure 16

To adjust, pull and hold the Recline Handle on the front of the booster Seat Base **1** and push the booster Seat Back towards the vehicle's seat back **2** until the back of this booster seat sits firmly against the vehicle seat back, as shown in **Figure 17**. Release Recline Handle.

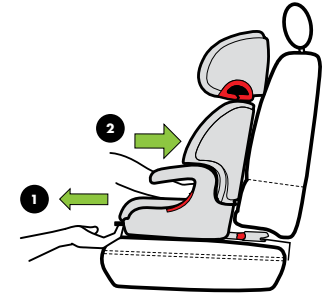

Figure 17

Ensure that the booster seat Headrest is in contact with the front surface of the vehicle seat back or headrest. **DO NOT** allow a gap between the booster seat Headrest and the vehicle seat back or headrest, as shown in **Figure 18**. A gap between the booster Seat Base and the vehicle seat back is acceptable when being used in the full back mode.



Figure 18

ADJUSTING THE SEAT BACK RECLINE (FULL BACK MODE WHEN USING LATCH CONNECTORS ONLY):

⚠ WARNING

- DO NOT ALLOW A GAP BETWEEN THIS BOOSTER SEAT HEADREST AND THE VEHICLE SEAT BACK OR VEHICLE HEADREST, AS SHOWN IN **FIGURE 19**. SUCH A GAP INCREASES THE RISK OF SERIOUS INJURY OR DEATH TO THE CHILD IN A SUDDEN STOP OR CRASH.
- NEVER ATTEMPT TO RECLINE THIS BOOSTER SEAT WHILE DRIVING.
- ALWAYS ENSURE THAT THE VEHICLE LAP AND SHOULDER BELT IS PROPERLY POSITIONED AND SNUGLY ADJUSTED ON THE CHILD.



Figure 19

To adjust to reclined position, pull on the Recline Handle located on the front of the Seat Base and slide this booster seat towards you to the desired recline position, as shown in **Figure 20**. Release Recline Handle to lock booster seat in the recline position. Make sure the booster seat Headrest remains in contact with the vehicle seat back or headrest.

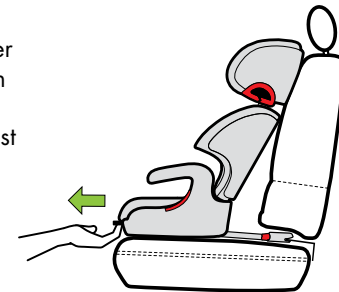

Figure 20

To return this booster seat to the upright position, pull and hold the Recline Handle with one hand **1** and then push this booster seat towards the vehicle seat back **2**, as shown in **Figure 21**. Release Recline Handle to lock booster seat in the upright position.

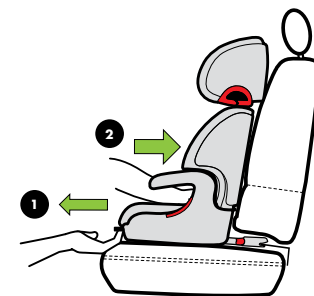

Figure 21

IMPORTANT: Always check vehicle seat belt fit on the child after adjusting the recline position of this booster seat. See **Step 7** of the “Securing Your Child in Booster Seat When Using Booster Seat in Full Back Mode (with Seat Back)” section of this manual on page 43.



Removing Booster Seat in Full Back Mode When Using LATCH Connectors

Step 1.

Pull on the Recline Handle located on the front of the booster Seat Base and slide this booster seat towards you exposing the LATCH Connectors ❶, as shown in **Figure 22**.

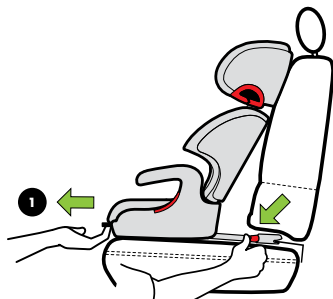

Figure 22

Step 2.

Locate the red buttons on the front of the LATCH Connectors. Releasing one LATCH connector at a time, use your thumb to press in on one button ❷ while using the other hand to pull this booster seat forward ❸, as shown in **Figure 23**. Repeat for the opposite LATCH connector.

To store the LATCH Connectors when not in use, pull and hold Recline Handle on front of booster Seat Base and then push LATCH Connectors into Seat Base.

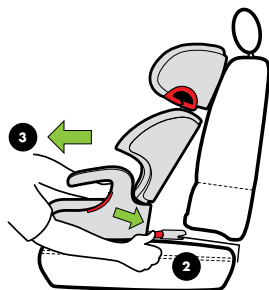

Figure 23

Step 3.

Remove this booster seat from vehicle.



Installing Booster Seat in Backless Mode When Using Latch Connectors

WARNING

- WHEN IN BACKLESS MODE, THE BACK OF THIS BOOSTER SEAT BASE MUST CONTACT THE VEHICLE SEAT BACK.

To remove Seat Back, see "Installing/Removing Seat Back" section on page 53.

Step 1.

Select a forward-facing vehicle seating location which has a lap and shoulder belt and LATCH Anchorage System.

If the vehicle seat back is adjustable, make sure the seat back is locked in the upright position. DO NOT allow the child to sit in this booster seat while the vehicle seat back is reclined, as shown in **Figure 24**.



Figure 24

Locate the LATCH lower anchors, as shown in **Figure 25**. See “Vehicle Child Restraint Anchorage System (LATCH)” section of this manual on page 13 or refer to your vehicle owner’s manual.

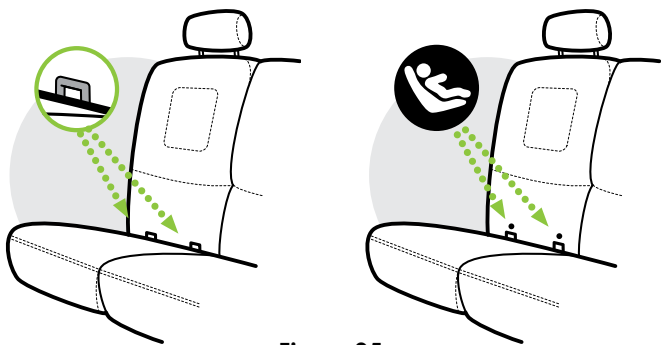

Figure 25

⚠ WARNING

- DO NOT USE LATCH CONNECTORS TO SECURE THIS BOOSTER SEAT TO THE VEHICLE’S LATCH ANCHORAGE SYSTEM IF THE SEAT BELT OR SEAT BELT BUCKLE IS NOT EASILY ACCESSIBLE WITH THIS BOOSTER SEAT LATCHED IN PLACE OR IF THE VEHICLE SEAT BELT BUCKLE IS LOCATED IN BETWEEN THE LATCH ANCHORS, AS SHOWN IN **FIGURE 26**. OR IF THE VEHICLE SEAT BELT IS LOCATED IN BETWEEN THE LATCH ANCHORS, AS SHOWN IN **FIGURE 27**.

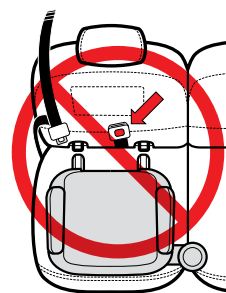

Figure 26

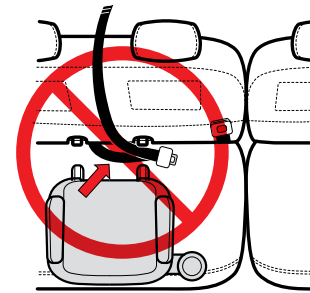

Figure 27

To connect to lower anchors, pull and hold Recline Handle on front of booster Seat Base **1** and pull LATCH Connectors out **2**, as shown in **Figure 28**.

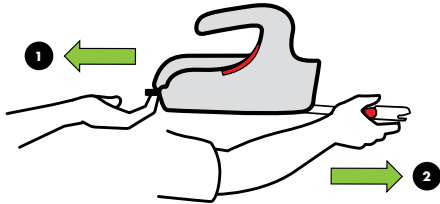

Figure 28

Step 2.

Place this booster seat in the seating location selected with the LATCH Connectors facing the vehicle seat.

Secure the LATCH Connectors to the vehicle LATCH lower anchors by aligning the LATCH Connectors with the vehicle LATCH anchors and pressing the LATCH Connectors against the LATCH lower anchors until you hear each LATCH Connector click, as shown in **Figure 29**.

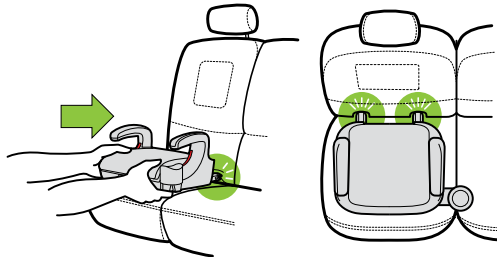

Figure 29

IMPORTANT: If LATCH Connectors fail to connect to the LATCH lower anchors, you can still use this seat. See section titled “Installing Booster Seat in Backless Mode WITHOUT Using LATCH Connectors” of this manual on page 36. However, please notify us if the LATCH Connectors fail to latch by calling 1-866-656-2462.

Step 3.

Once the LATCH Connectors are securely connected to the LATCH lower anchors, pull forward on this booster seat to make sure it is securely attached to the vehicle’s LATCH lower anchors on both sides. If not, start over at **Step 1**.

Step 4.

Complete installation by adjusting this booster seat so the back of this booster seat contacts the front of the vehicle seat back, as shown in **Figure 30**.

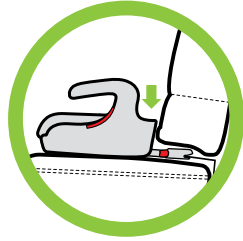

Figure 30

To adjust, pull and hold the Recline Handle on the front of this booster Seat Base **1** and push this booster seat towards the vehicle's seat back **2** until the back of this booster seat sits firmly against the vehicle seat back, as shown in **Figure 31**. Release Recline Handle.

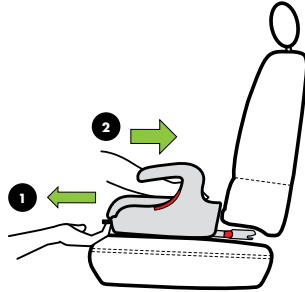

Figure 31

Ensure that this booster seat is in contact with the front surface of the vehicle seat back. **DO NOT** allow a gap between this booster seat and the vehicle seat back, as shown in **Figure 32**.



Figure 32



Removing Booster Seat in Backless Mode When Using LATCH Connectors

Step 1.

Pull on the Recline Handle located on the front of this booster Seat Base and slide this booster seat towards you exposing the LATCH Connectors **1**, as shown in **Figure 33**.

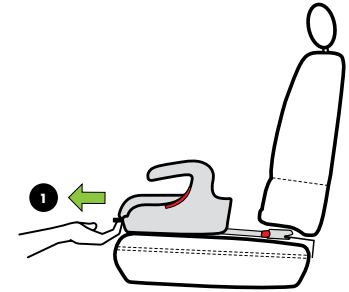

Figure 33

Step 2.

Locate the red buttons on the front of the LATCH Connectors. Releasing one LATCH Connector at a time, use your thumb to press in on one button **2** while using the other hand to pull this booster seat forward **3**, as shown in **Figure 34**. Repeat for the opposite LATCH Connector.

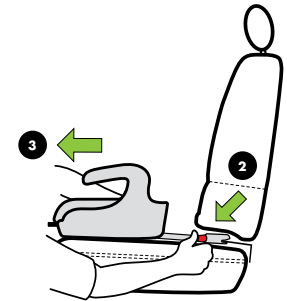

Figure 34

To store the LATCH Connectors when not in use, pull and hold Recline Handle on front of booster Seat Base and then push LATCH Connectors into Seat Base.

Step 3.

Remove this booster seat from vehicle.

Installing Booster Seat WITHOUT Using LATCH Connectors

WARNING

- FAILURE TO PROPERLY INSTALL OR USE THIS BOOSTER SEAT INCREASES THE RISK OF SERIOUS INJURY OR DEATH TO THE CHILD AND OTHERS IN A SHARP TURN, SUDDEN STOP OR CRASH.
- TO AVOID INJURY THIS BOOSTER SEAT MUST BE INSTALLED BY AN ADULT.
- NEVER LEAVE THIS BOOSTER SEAT UNSECURED IN YOUR VEHICLE. THIS BOOSTER SEAT MUST REMAIN CONNECTED TO THE LATCH LOWER ANCHORS IN THE VEHICLE OR SECURED BY THE VEHICLE'S SEAT BELT EVEN WHEN NOT IN USE. IN A SHARP TURN, CRASH OR SUDDEN STOP, AN UNSECURED BOOSTER SEAT CAN BE THROWN AROUND AND COULD SEVERELY INJURE VEHICLE OCCUPANTS.
- WHEN NOT USING LATCH CONNECTORS, THE BACK OF THIS BOOSTER SEAT BASE MUST CONTACT THE VEHICLE SEAT BACK.



Installing Booster Seat in Full Back Mode WITHOUT Using LATCH Connectors

To install Seat Back, see "Installing/Removing Seat Back" section of this manual on page 53.

Step 1.

Select a forward-facing vehicle seating location, which has a lap and shoulder belt.

If the vehicle seat back is adjustable, make sure the seat back is locked in the upright position. DO NOT allow the child to sit in booster seat while the vehicle seat is reclined, as shown in **Figure 35**.

Check that LATCH Connectors are fully retracted.

To fully retract LATCH Connectors, pull and hold Recline Handle on front of booster seat and push LATCH Connectors into Seat Base.



Figure 35

Step 2.

Center this booster seat on the vehicle seat and position this booster seat firmly against seat back with LATCH Connectors tucked into the crease between the vehicle seat back and vehicle seat cushion.

Step 3.

Ensure that the booster Seat Base is in contact with the vehicle seat back, as shown in **Figure 36**.



Figure 36



Figure 37

DO NOT allow gap between the booster Seat Base and vehicle seat back, as shown in **Figure 37**.



Installing Booster Seat in Backless Mode WITHOUT Using LATCH Connectors

To remove Seat Back, see "Installing/Removing Seat Back" section of this manual on page 53.

Step 1.

Select a forward-facing vehicle seating location, which has a lap and shoulder belt.

If the vehicle seat back is adjustable, make sure the seat back is locked in the upright position. DO NOT allow the child to sit in this booster seat while the vehicle seat is reclined, as shown in **Figure 38**.

Check that LATCH Connectors are fully retracted.

To fully retract LATCH Connectors, pull and hold Recline Handle on front of booster seat and push LATCH Connectors into Seat Base.



Figure 38

Step 2.

Center this booster seat on the vehicle seat and position this booster seat firmly against seat back with LATCH Connectors tucked into the crease between the vehicle seat back and vehicle seat cushion.

Step 3.

Ensure that the booster Seat Base is in contact with the vehicle seat back, as shown in **Figure 39**.



Figure 39



Figure 40

DO NOT allow gap between the booster Seat Base and vehicle seat back, as shown in **Figure 40**.

Securing Your Child in Booster Seat

WARNING

- USE ONLY A VEHICLE'S LAP AND SHOULDER BELT SYSTEM WHEN RESTRAINING THE CHILD IN THIS BOOSTER SEAT.
- VEHICLE LAP AND SHOULDER BELT MUST BE PROPERLY POSITIONED AND SNUGLY ADJUSTED ON CHILD.
- NEVER USE ONLY A LAP BELT TO RESTRAIN A CHILD IN THIS BOOSTER SEAT. USE WITHOUT A LAP AND SHOULDER BELT CAN RESULT IN SERIOUS INJURY OR DEATH.
- TO AVOID INJURY, THE CHILD MUST BE SECURED BY AN ADULT. NEVER ALLOW THE CHILD TO BUCKLE THEMSELVES IN THIS BOOSTER SEAT.
- TO AVOID SERIOUS ABDOMINAL INJURY OR DEATH, A CHILD MUST SIT UPRIGHT AND NOT SLOUCH IN THIS BOOSTER SEAT. IF THE CHILD CANNOT MAINTAIN AN UPRIGHT POSITION IN THIS BOOSTER SEAT WITH THEIR BACK AND BUTTOCKS IN CONTACT WITH THE SEAT BACK, DO NOT USE THIS BOOSTER SEAT WITH THE CHILD.
- TO AVOID BURN INJURY — ALWAYS TOUCH THE SURFACES OF THE PARTS BEFORE PUTTING THE CHILD IN THIS BOOSTER SEAT. THIS BOOSTER SEAT CAN BECOME VERY HOT IF LEFT IN THE SUN AND COULD BURN THE CHILD'S SKIN.



When Using Booster Seat in Full Back Mode (with Seat Back):

Height	Weight	Recommended Age
38–57 in. 96–145 cm.	33–100 lb. 15–45 kg.	4 years & up

WARNING

- DISCONTINUE USE OF THIS BOOSTER SEAT IN FULL BACK MODE IF TOPS OF CHILD'S EARS ARE ABOVE THE BOOSTER SEAT HEADREST IN THE HIGHEST ADJUSTMENT POSITION. SEVERE HEAD OR NECK INJURIES COULD RESULT WITHOUT PROPER HEAD SUPPORT.

Step 1.

The child **MUST** sit in this booster seat with their back flat against the Seat Back, as shown in **Figure 41**.

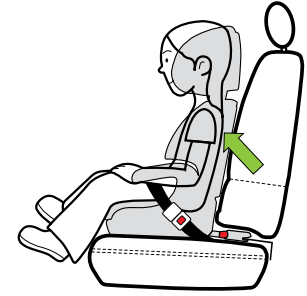

Figure 41

Step 2.

Position the lap belt underneath the Armrest on the side opposite the vehicle seat belt buckle, as shown in **Figure 42**.

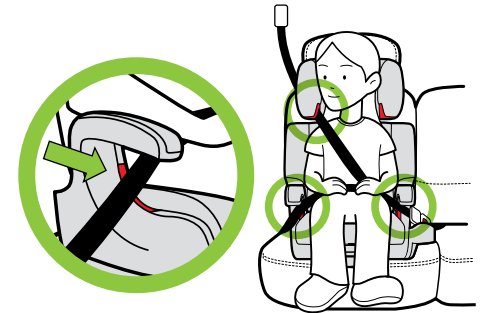

Figure 42

Step 3.

Pull the lap and shoulder belt over the child while positioning BOTH the lap and shoulder belt underneath the Armrest on the vehicle seat belt buckle side and buckle the seat belt, as shown in **Figure 43**.

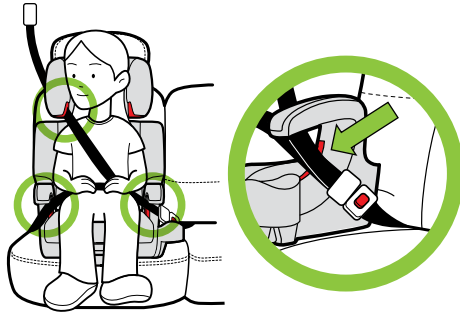

Figure 43

Step 4.

Route shoulder belt through the Shoulder Belt Guide on the side that the vehicle shoulder belt will contact the child's shoulder, as shown in **Figure 44**.



Figure 44

Step 5.

Adjust Headrest height.

The bottom of the Shoulder Belt Guide should be at or above the top of the child's shoulders, as shown in **Figure 45**.



Figure 45

The tops of the child's ears MUST be below the top of this booster seat's Headrest, as shown in **Figure 46**.

To adjust Headrest height, see "Adjusting the Headrest" section of this manual on page 46.



Figure 46

Step 6.

Pull on shoulder belt to remove all slack out of the lap and shoulder belt and snugly adjust the vehicle seat belt onto the child.

IMPORTANT: Design and operation of vehicle seat belt systems vary from vehicle to vehicle and from seating location to seating location within the same vehicle. Refer to your vehicle owner's manual for proper use, placement and adjustment of the vehicle's lap and shoulder belts.

Step 7.

Check vehicle seat belt fit on the child:

- Vehicle seat belts **MUST** fit snugly and lay flat against the child and **MUST** not be loose or twisted. A snug seat belt does not allow any slack. It lies in a relatively straight line without sagging.
- The lap belt **MUST** sit low and snugly on the child's hips. Pull on the shoulder belt to tighten.
- The shoulder belt **MUST** be at or above the child's shoulder, lie snugly across the mid point of the child's chest and across the center of the shoulder in the **GREEN** zone, as shown in **Figure 47**.

If the shoulder belt is not positioned properly, adjust the Headrest to change the shoulder belt position. (See "Adjusting the Headrest" section of this manual on page 46.)

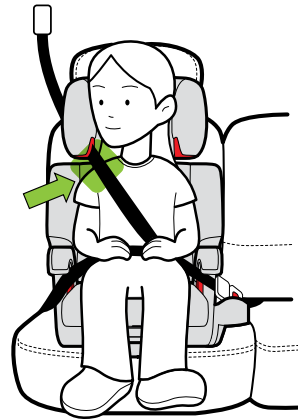

Figure 47

IMPORTANT: If the shoulder belt is off the child's shoulder, not centered on the child's chest, or the ears are above the top of the headrest in the highest adjustment position, then your child is too large to use this booster seat in full back mode.

- **DO NOT** position any part of the vehicle seat belt over the top of the Armrest, as shown in **Figure 48**, behind the Armrest, as shown in **Figure 49**, under the child's arm, as shown in **Figure 50**, or behind the child, as shown in **Figure 51**.



Figure 48



Figure 49



Figure 50

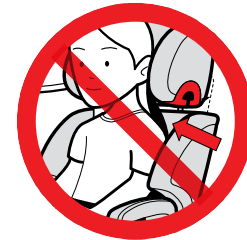

Figure 51

DO NOT use with the vehicle shoulder belt touching the child's neck, as shown in **Figure 52**, or face, as shown in **Figure 53**.



Figure 52



Figure 53

To avoid serious abdominal injury or death, a child **MUST** sit upright and not slouch in this booster seat, as shown in **Figure 54**. If the child cannot maintain an upright position in this booster seat with their back and buttocks in contact with this booster Seat Back, DO NOT use this booster seat.



Figure 54

ADJUSTING THE HEADREST:

Step 1.

With child sitting in this booster seat, have your child lean forward.

Step 2.

Press the button on the Headrest Adjuster on the right-hand side of the seat (when facing front of seat) **1** and raise or lower the Headrest into one of the 11 height positions **2**, as shown in **Figure 55**. Release button on the Headrest Adjuster to lock in place.

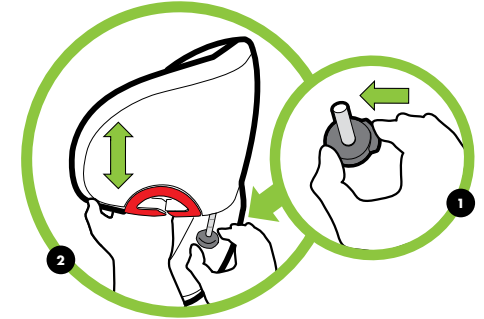

Figure 55

Step 3.

Check to make sure the Headrest is locked in place by pulling up on the Headrest.

Step 4.

Check for proper shoulder belt fit. See **Step 7** of the "Securing Your Child in Booster Seat When Using Booster Seat in Full Back Mode (with Seat Back)" section of this manual on page 43.



When Using Booster Seat in Backless Mode (without Seat Back):

Height	Weight	Recommended Age
40–57 in. 101–145 cm.	40–100 lb. 15–45 kg.	4 years & up

WARNING

- DISCONTINUE USE OF THIS BOOSTER SEAT IN BACKLESS MODE IF TOPS OF THE CHILD'S EARS ARE ABOVE THE VEHICLE SEAT BACK OR HEADREST IN THE HIGHEST ADJUSTMENT POSITION. SEVERE HEAD OR NECK INJURIES COULD RESULT WITHOUT PROPER HEAD SUPPORT.

Step 1.

The child **MUST** sit in this booster seat with their back flat against the vehicle seat back, as shown in **Figure 56**.

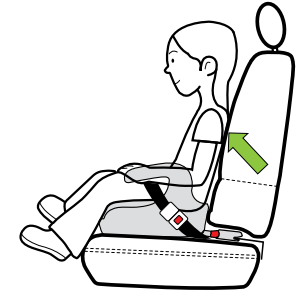

Figure 56

Step 2.

Ensure that the vehicle seat back or headrest is high enough to support the child's head. See your vehicle owner's manual on how to adjust the vehicle headrest.

The tops of the child's ears **MUST** be below the top of the vehicle seat back or headrest in the highest adjustment position, as shown in **Figure 57**. Severe head or neck injuries could result without proper head support.



Figure 57

Step 3.

Position the lap belt underneath the Armrest on the side opposite the vehicle seat belt buckle, as shown in **Figure 58**.

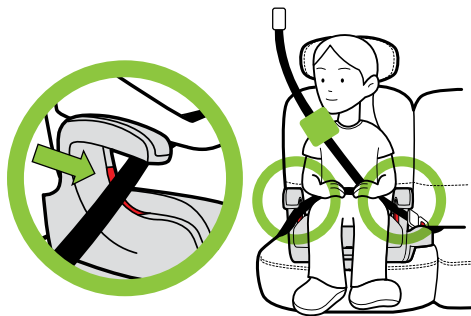

Figure 58

Step 4.

Pull the lap and shoulder belt over the child while positioning BOTH the lap and shoulder belt underneath the Armrest on the vehicle seat belt buckle side, as shown in **Figure 59**. Buckle the seat belt.

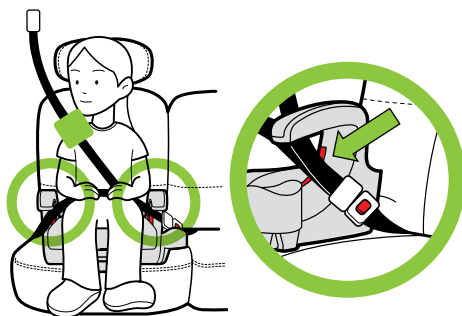

Figure 59

Step 5.

Pull on the shoulder belt to remove all slack out of the lap and shoulder belt and snugly adjust the vehicle seat belt onto the child.

IMPORTANT: Design and operation of vehicle seat belt systems vary from vehicle to vehicle and from seating location to seating location within the same vehicle. Refer to your vehicle owner's manual for proper use, placement and adjustment of the vehicle's lap and shoulder belts.

Step 6.

Check vehicle seat belt fit on the child:

- Vehicle seat belts **MUST** fit snugly and lay flat against the child and **MUST** not be loose or twisted. A snug seat belt does not allow any slack. It lies in a relatively straight line without sagging.
- The lap belt **MUST** sit low and snugly on the child's hips. Pull on the shoulder belt to tighten.
- When sitting on this booster seat, the shoulder belt **MUST** lie snugly across the mid point of the child's chest and across the center of the shoulder in the **GREEN** zone, as shown in **Figure 60**.

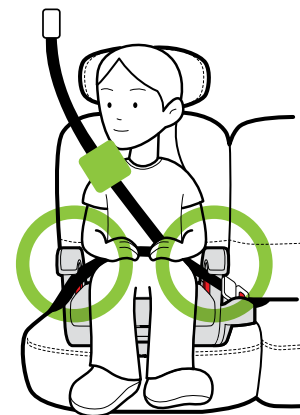

Figure 60

IMPORTANT: If the shoulder belt is off the child's shoulder, not centered on the child's chest, or the ears are above the top of the vehicle seat back or headrest in the highest adjustment position, then your child is too large to use this booster seat in backless mode.

- DO NOT position any part of the vehicle seat belt over the top of the Armrest, as shown in **Figure 61**, behind the Armrest, as shown in **Figure 62**, under the child's arm, as shown in **Figure 63**, or behind the child, as shown in **Figure 64**.



Figure 61



Figure 62



Figure 63



Figure 64

- DO NOT use with the vehicle shoulder belt touching the child's neck, as shown in **Figure 65**, or face, as shown in **Figure 66**, or off their shoulder, as shown in **Figure 67**.



Figure 65



Figure 66



Figure 67

- To avoid serious abdominal injury or death, a child MUST sit upright and not slouch in this booster seat, as shown in **Figure 68**. If the child cannot maintain an upright position with their back in contact with the vehicle seat back and their buttocks in contact with this booster seat, DO NOT use this booster seat.



Figure 68

Installing/Removing Seat Back

To Remove the Seat Back:

Step 1.

Facing the front of this booster seat, tilt this booster seat counter-clockwise, resting it on its side, as shown in **Figure 69**.

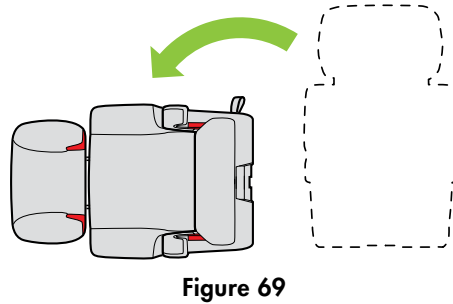

Figure 69

Step 2.

Locate the Seat Back Release Strap on the bottom right side of seat.

Step 3.

While holding the top of the Seat Back, pull and hold the Release Strap and then slide the Seat Back out of the Seat Base, as shown in **Figure 70**.

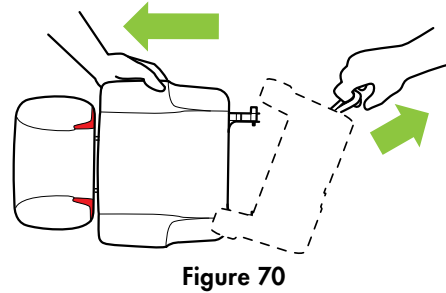

Figure 70

Step 4.

Once the Seat Back leg is released, complete removal by rotating the opposite Seat Back leg out of opening in the Seat Base.

To Install the Seat Back:

Step 1.

Facing the back of the Seat Base, align the Seat Back legs in the openings in the Seat Base behind the Armrests, as shown in **Figure 71**.

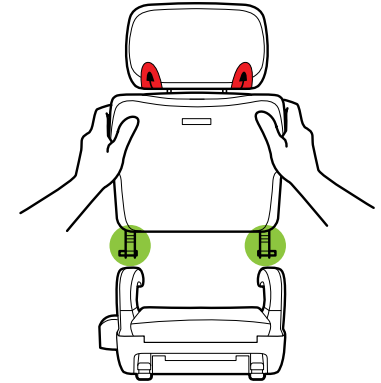

Figure 71

Step 2.

Lower the Seat Back leg on the right and slide into the opening to engage the back leg, as shown in **Figure 72**. Rotate the left side of the booster Seat Back down and align the Seat Back leg with the opening in the Seat Base.

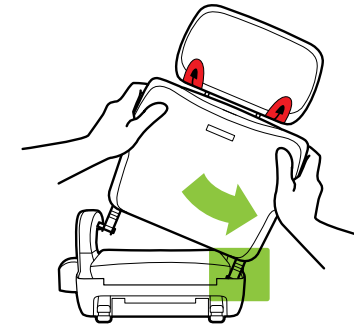

Figure 72

Step 3.

Press the left leg into the Seat Back lock (listen for audible click), as shown in **Figure 73**.

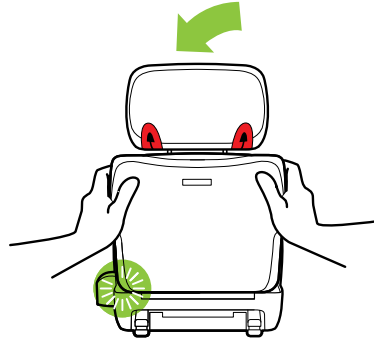

Figure 73

Step 4.

Once the Seat Back is installed, pull up on the Seat Back to ensure it is securely locked in place, as shown in **Figure 74**.

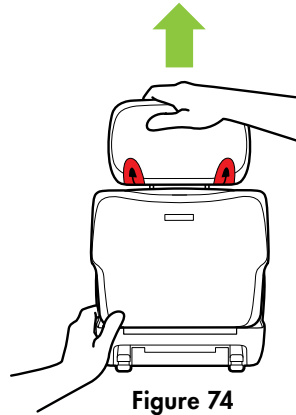

Figure 74

Step 5.

If Seat Back is not locked, repeat **Steps 1–4**, above.

Installing/Removing Cup Holder (**drink-thingy™**)

To Install Cup Holder (**drink-thingy™**):

Step 1.

Remove Seat Cushion from Seat Base and set Seat Cushion to side. (See section titled "Removing/Installing Seat Cushion & Seat Cushion Cover," on page 58.)

Step 2.

Locate Cup Holder slots on front corners of Seat Base, as shown in **Figure 75**.

Step 3.

Align tabs of Cup Holder to slots in Seat Base, as shown in **Figure 76**.

Step 4.

Slide Cup Holder tabs into slots ensuring top and bottom tabs are fully engaged, as shown in **Figure 77**.

Step 5.

Install Seat Cushion back onto Seat Base. (See section titled "Removing/Installing Seat Cushion & Seat Cushion Cover," on page 58.)



Figure 75

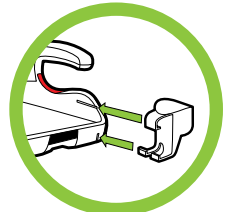

Figure 76

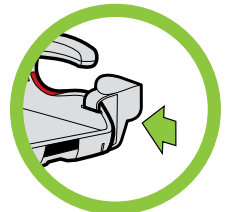

Figure 77

To Remove Cup Holder (drink-thingy™):

Step 1.

Remove Seat Cushion from Seat Base and set Seat Cushion to side. (See section titled "Removing/Installing Seat Cushion & Seat Cushion Cover," on page 58.)

Step 2.

Holding onto the outside of the Cup Holder, slide Cup Holder tabs out of slots in Seat Base.

Step 3.

Install Seat Cushion back onto Seat Base. (See section titled "Removing/Installing Seat Cushion & Seat Cushion Cover," on page 58.)

Instruction Manual Storage

After carefully reading and following these instructions, keep this manual for future use and store in the compartment located on the bottom of the Seat Base, as shown in **Figure 78**.

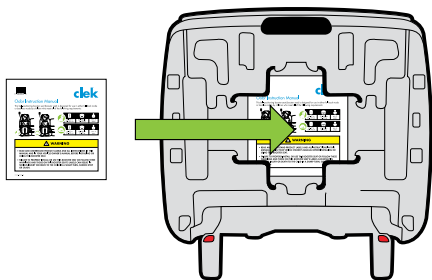

Figure 78

Care & Cleaning

Removing/Installing Seat Cushion & Seat Cushion Cover



- NEVER USE BOOSTER SEAT WITHOUT SEAT CUSHION IN PLACE.

To Remove Seat Cushion Cover:

Step 1.

To remove Seat Cushion Cover, you must first remove the entire Seat Cushion from the Seat Base.

Step 2.

Pull up on bottom front edge of Seat Cushion to release it from the front of the Seat Base, as shown in **Figure 79**.

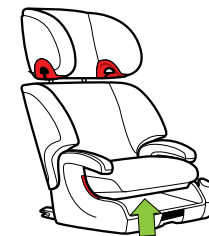

Figure 79

Step 3.

Pull the Seat Cushion forward to fully release it from the Seat Base, as shown in **Figure 80**.

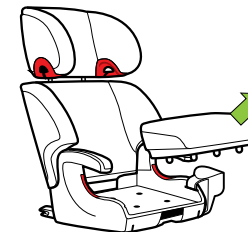

Figure 80

Step 4.

Turn Seat Cushion over to locate the Seat Cushion Cover attachments, as shown in **Figure 81**.

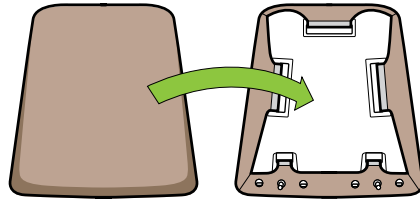

Figure 81

Step 5.

Using your thumb, push inward on each Seat Cushion Cover attachment one at a time to release the Cover from the Seat Cushion, as shown in **Figure 82**.

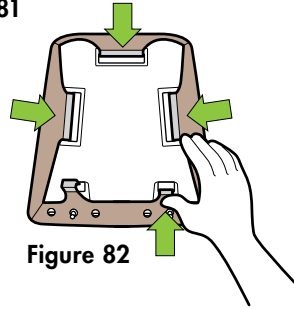

Figure 82

Step 6.

Remove Seat Cushion Cover from Seat Cushion, as shown in **Figure 83**.

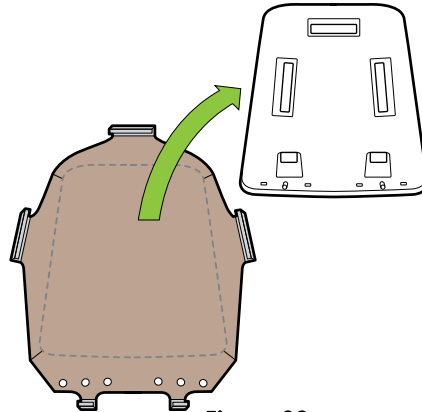

Figure 83

To Install Seat Cushion Cover:

Step 1.

Place Seat Cushion Cover on a flat surface with Seat Cushion Cover attachments facing up, as shown in **Figure 84**.

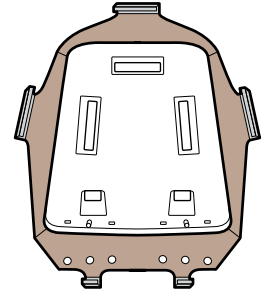

Figure 84

Step 2.

Place Seat Cushion into Seat Cushion Cover, aligning the seat cushion with the Seat Cushion Cover attachments.

Step 3.

Reattach Seat Cushion Cover attachments to Seat Cushion by wrapping the Seat Cushion Cover sides around the entire Seat Cushion, as shown in **Figure 85**.

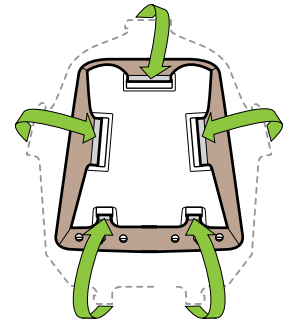

Figure 85

To Install Seat Cushion:

Step 1.

Place Seat Cushion onto top surface of Seat Base.

Step 2.

Slide Seat Cushion rearward underneath Seat Back to align snaps in Seat Base, as shown in **Figure 86**.

Step 3.

Press down on rear and front of Seat Cushion to engage front snaps to Seat Base.

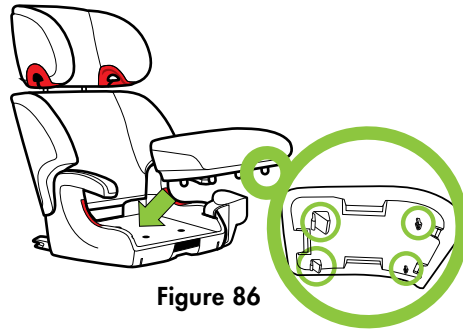

Figure 86

Washing Instructions

SEAT CUSHION COVER WASHING INSTRUCTIONS

Step 1.

Once the Seat Cushion Cover is removed, set the foam pad aside. DO NOT wash foam pad.

Step 2.

Follow washing instructions on wash tag located on inside of Seat Cushion Cover.

SEAT BACK COVER & HEADREST COVER FABRIC WASHING INSTRUCTIONS

IMPORTANT: The booster Seat Back Cover and Headrest Cover are not removable for washing.

Step 1.

If the spot has dried, try lightly brushing or scraping off the residual. Wipe surface with water.

Step 2.

If a spot still remains, apply a mild detergent to fabric with a light mist.

Step 3.

Work area using soft brush or edge of spoon from outside of spot towards the middle.

Step 4.

Allow solution to work for approximately one minute.

Step 5.

Remove with clean water or blot with clean soft towel.

Step 6.

Repeat **Steps 3-5** as necessary until spot is removed.

Step 7.

Rinse with clear lukewarm water and blot with clean soft white cloth as final step.

SEAT FRAME (EXTERIOR PLASTICS ONLY) WASHING INSTRUCTIONS

Use a soft cloth with warm water and soap. Apply light pressure with cloth in small circular motions.

Accessories

Optional trim covers and accessories for this product may be purchased at:
<http://www.shopclek.com>

Warranty

Limited Warranty

Clek Inc. warrants, only to the original consumer purchaser and only if this product was purchased (new and unused in an unopened box) from an authorized Clek retailer listed at www.clekinc.com, that this product will be free from defects in material and workmanship for one (1) years from the date of original purchase (the "Warranty Period"). During the Warranty Period, Inc. will, at its option, repair or replace this product if it is found by the manufacturer to be defective in material or workmanship. Clek Inc. reserves the right to discontinue or change parts, fabrics, models, or products, or to substitute this product with a comparable model or product. To make a claim under this warranty, please contact us at http://www.clekinc.com/contact_us/, call us at 1-866-656-2462, or write to us at Clek Inc., Attn: Customer Service, Clek Inc., 12 Upjohn Rd., Suite 1, Toronto, Ontario, Canada M3B 2V9. An original receipt is required to validate your warranty and shipping charges will be the responsibility of the original consumer purchaser. To expedite the processing of any future warranty claims and to verify the original date of purchase, please complete and mail the pre-addressed owner registration card within thirty (30) days of purchase.

Warranty Limitations

This warranty does not cover the effects of normal wear and tear or damage resulting from negligence, modification, improper installation, accidents, misuse or abuse of this product. It is expressly agreed that the obligations of Clek Inc. and the original consumer purchaser's remedies under the limited warranty contained herein are exclusive and are strictly limited to the repair or replacement of the product. This limited warranty is conditional upon strict compliance with the provisions of the Instruction Manual. In no event will Clek Inc. or the dealer selling this product be liable to you for any damages, including incidental or consequential damages, arising out of the use or inability to use this product.

Limitation of Warranties and State/Provincial Law Rights:

The warranty and remedies as set forth above are exclusive and in lieu of all others, oral or written, express or implied. To the extent permitted by applicable law, any implied warranties, including implied warranties of merchantability and fitness for a particular purpose, are hereby disclaimed. Some states/provinces DO NOT allow limitations as to how long an implied warranty lasts or the exclusion or limitation of incidental or consequential damages, so the above limitations may not apply to you. This warranty gives you specific legal rights, and you may have other rights, which vary from state/province to state/province. Neither Clek Inc. nor the dealer selling this product has authorized any person to create for it any other warranty, obligation, or liability in connection with this product.

Keep this Instruction Manual for future use.
Store in compartment on bottom of this booster seat.

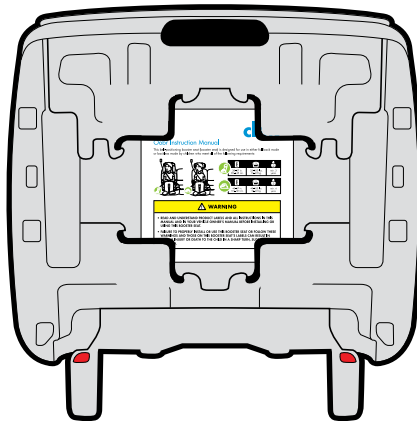

www.clekinc.com

Clek Inc.
12 Upjohn Rd., Suite 1
Toronto, Ontario Canada
M3B 2V9
1-866-656-2462